

Lease Plan

2-8 ANTON STREET

LONDON, E8

Ground Floor - Office A+E

— Lease Demise

ANTON STREET

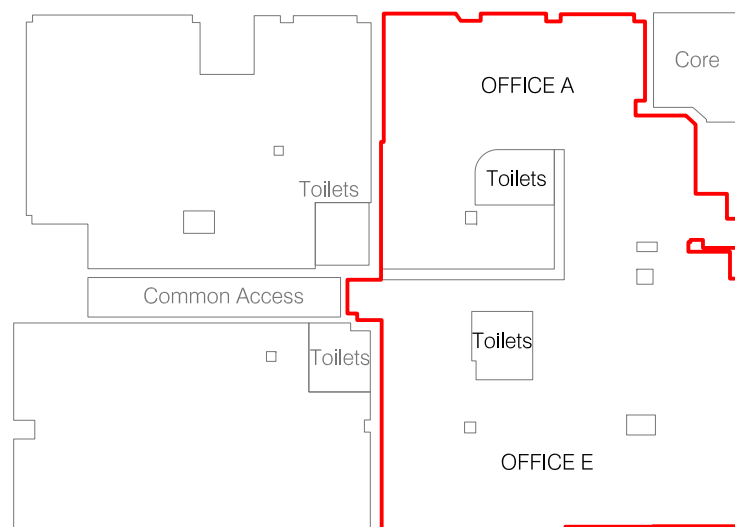
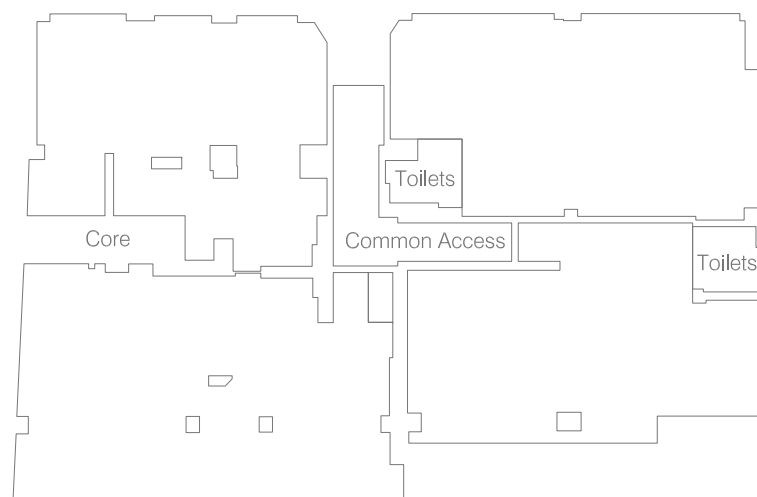

ANDRE STREET

Notes:

Care should be taken when drawings are printed to avoid image distortion.

This drawing is issued for lease registration purposes only and further copies should be printed under the appropriate licence.

This lease plan is compiled from client supplied data.

Revisions:

- A - Original Issue (June 2009)
- B -
- C -
- D -
- E -
- F -

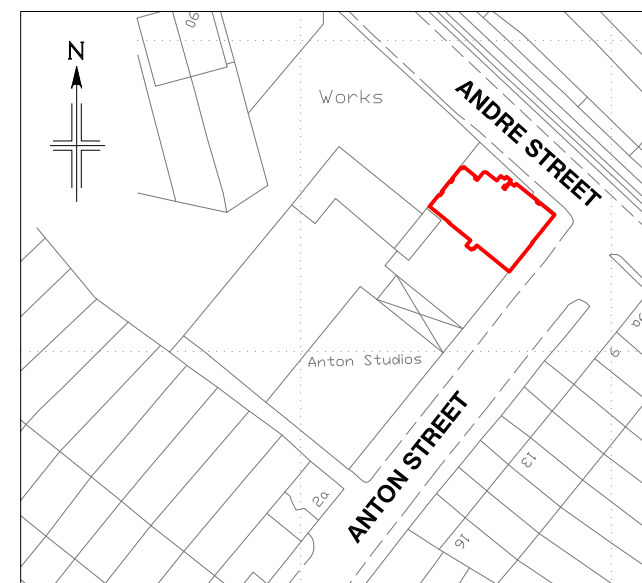

Location Plan

Scale 1:1250

This drawing contains Ordnance Survey data which has been reproduced with the permission of the Controller of Her Majesty's Stationery Office, Crown copyright 2003. Plowman Craven Licence Number 100020449

Drawing No. 18000-35-A-E-AG

Issue A

June 2009

Presentation Scale 1:250 @ A3

Plowman Craven PCA

+44(0)1582 765566
 info@plowmancraven.co.uk
 +44(0)1582 765370
 www.plowmancraven.co.uk

