

1 IF IN DOUBT - ASK
 2 DO NOT SCALE OFF THIS DRAWING
 3 ALL DIMENSIONS ARE TO BE VERIFIED ON SITE BY THE CONTRACTOR AND ANY DISCREPANCIES REPORTED TO THE ARCHITECT BEFORE CONSTRUCTION
 4 THIS DRAWING IS TO REPLACE THE PREVIOUSLY ISSUED DRAWING
 5 COPYRIGHT OF THIS DRAWING REMAINS WITH THE ARCHITECT

No.	Date	Revision
-	-	-

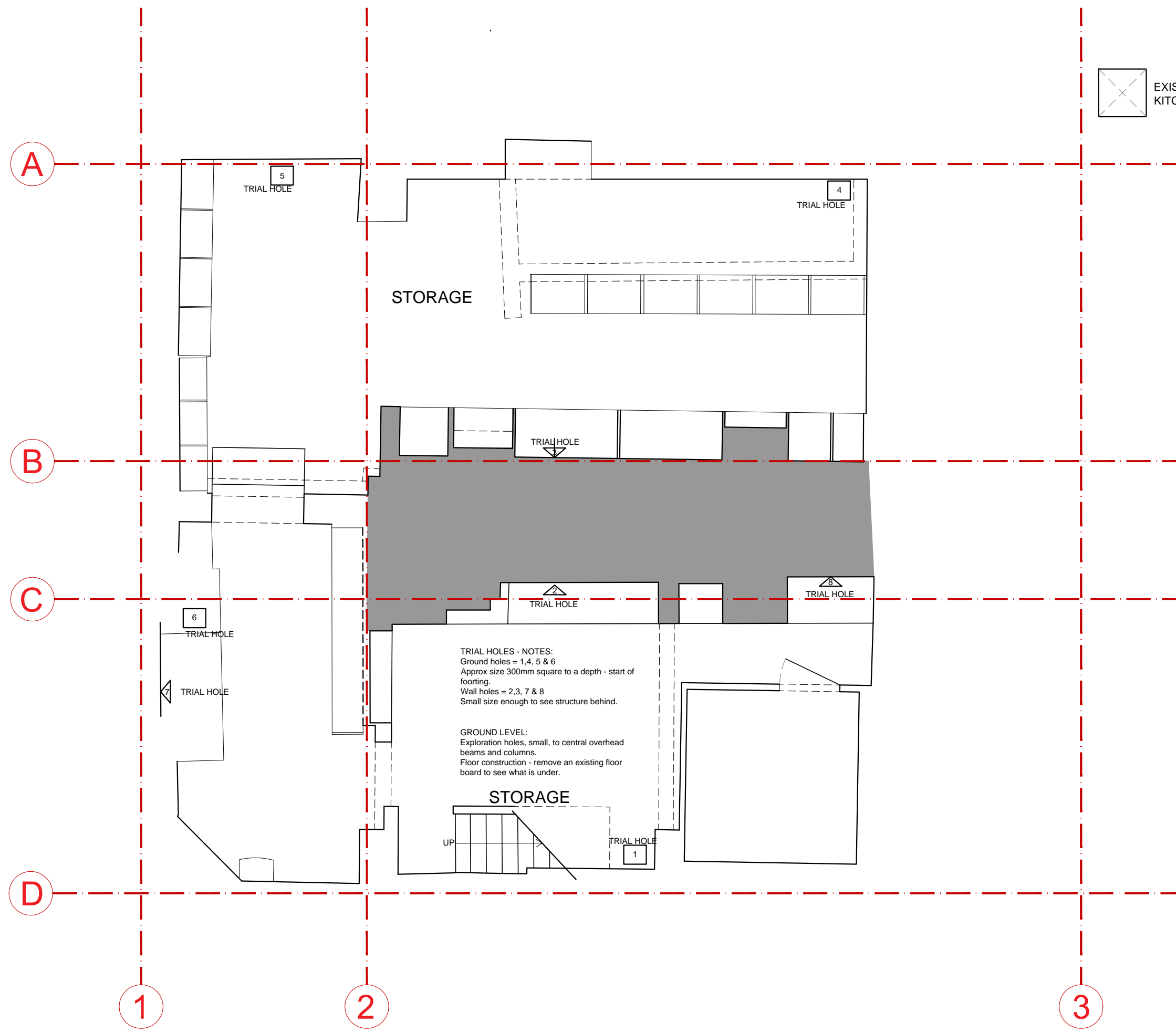

TRIAL HOLES - NOTES:
 Ground holes = 1, 4, 5 & 6
 Approx size 300mm square to a depth - start of footing.
 Wall holes = 2, 3, 7 & 8
 Small size enough to see structure behind.

GROUND LEVEL:
 Exploration holes, small, to central overhead beams and columns.
 Floor construction - remove an existing floor board to see what is under.

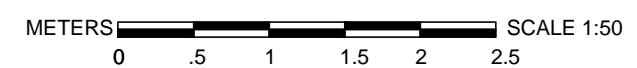

INVESTIGATIVE WORKS TO THE EXISTING BASEMENT PLAN

MITTELMAN ASSOCIATES LLP C22A PARKHALL ESTATE 40 MARTELL ROAD LONDON SE21 8EN TEL 020 8768 8400 FAX 020 8655 7043 e-mail: info@mittelman.co.uk ARCHITECTURE		
Stage: Planning		
Project: Suna House 128-130 Curtain Road		
Client: Leamington Holdings Inc		
Drawing Title: EXIST BASEMENT - TRIAL HOLES		
Scale: 1:50	Project No.: 2019 - 734	Rev.:
Date: JULY 2019	Drawing No.: PL07	-