

The following areas have been INCLUDED in the IPMS Area:

	OFFICE	952.9 sq m	10257 sq ft
	COLUMN	2.3 sq m	24 sq ft

TOTAL IPMS AREA:
955.1 sq m 10281 sq ft

The following areas have been INCLUDED in the NIA:

	OFFICE	952.9 sq m	10257
--	--------	------------	-------

The following areas have been EXCLUDED from the NIA:

	COLUMN	2.3 sq m	24 sq ft
--	--------	----------	----------

TOTAL NIA:
952.9 sq m 10257 sq ft

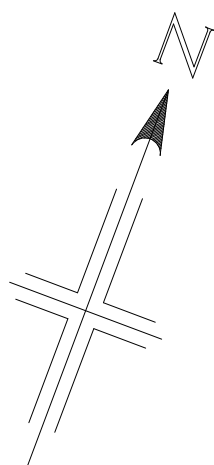
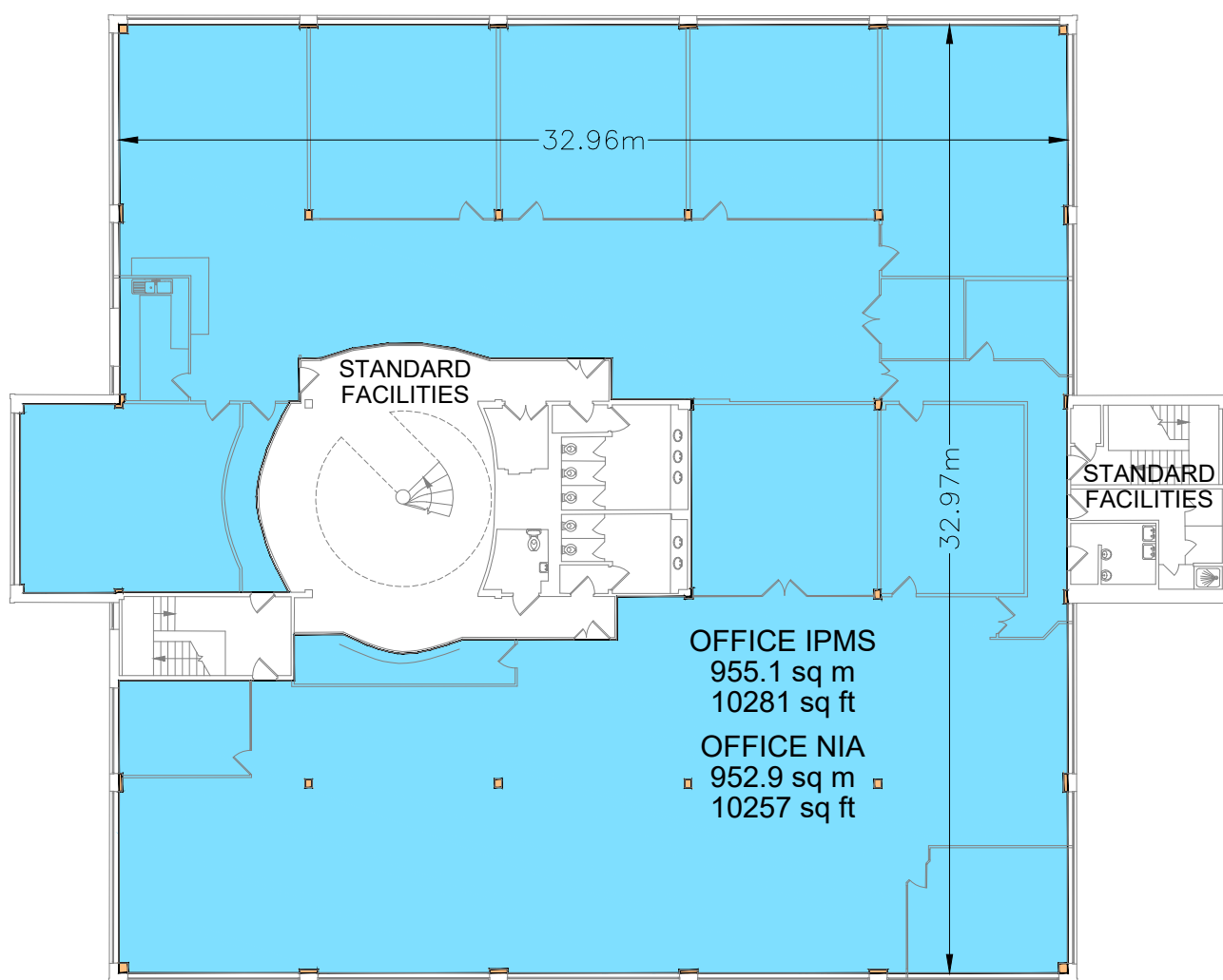

Scale 1:250

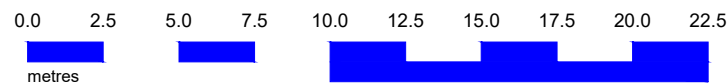

AREA MEASURED TO IPMS 3.2 STANDARD ON THE 09/03/2023 USING TRIMBLE X7 LASER SCANNER.
CONVERSION FROM sq m to sq ft = 10.7639.

TITLE
**MAGINUS SOFTWARE
FLOATS ROAD
WYTHENSHAW**
LEVEL 1 IPMS AREA PLAN

SURVEYED BY PSL	DRAWN BY KM	SCALE 1:100
DATE OF ISSUE MARCH 2023		@ A3
DRAWING No. PS-2322-IPMS-L1		ISSUE 00
SHEET 1 OF 1		

PARAGON SURVEYS
Chartered Surveyors
GEOMATICS: Land & Engineering Surveyors

292 Wood Lane
Heskin, Chorley
Lancashire
PR7 5NT
Tel: (01257) 453200
Fax: (01257) 453211
Email: post@ParagonSurveys.co.uk

