



FOR SALE: RUBY HOUSE

Ruby Lane, Aberdeen, AB10 1ZP

Office Building with Planning Permission for Conversion to 59 Apartments



SUMMARY

- Four storey, L shaped detached office building
- Located in the heart of Aberdeen City Centre, in close proximity to the newly refurbished Union Terrace Gardens
- Planning Permission granted for conversion from office accommodation to 59 residential apartments
- Offers invited for the whole with vacant possession

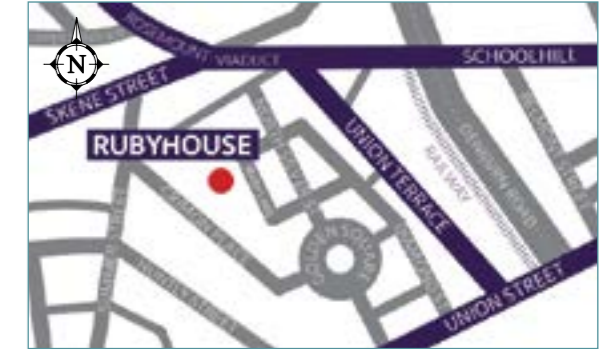

LOCATION

Ruby House is located in a mixed residential and business location in the heart of Aberdeen City Centre in close proximity to the newly refurbished Union Terrace Gardens. It is around 250m to the north of Union Street, the main retail thoroughfare within Aberdeen. The location of the property allows for easy access to all the amenities contained within the City Centre including schooling, shopping and various cultural venues including a theatre, art gallery and library all within 500m of Ruby House. Ruby House is within the catchment for Gilcomstoun Primary School, and Aberdeen Grammar School for secondary education.

Aberdeen is considered the Energy Capital of Europe and is Scotland's third city with a population of circa 225,000 and a catchment in excess of 500,000. The city has a thriving student population, in the region of 22,000, being home to two universities. 47% of the city centre population is aged between 26 and 40. In recent times Aberdeen has seen a 50% reduction in available rental properties resulting in a significant 13% rise in rentals between Q1 2022 and Q2 2023 (Citylets).

DESCRIPTION

Built in 1979, Ruby House forms a four storey, L shaped detached office building of concrete construction along with 36 no car parking spaces. The development opportunity is a rare and welcome commodity within the City Centre. Ruby House and the car parking are accessed from Ruby Lane and the entire site extends to approx. 0.35 ha (0.87 acres).

PLANNING

Detailed Planning Permission (220346/ DPP) was granted by Aberdeen City Council for the conversion of Ruby House from office accommodation to 59 residential apartments on 29th November 2022. The 59 flats would comprise 37 1-bed units and 22 2-bed units. Consent was granted subject to certain conditions. Full information regarding the planning consent can be obtained from the selling agents or via the planning portal on Aberdeen City Councils website:

<https://publicaccess.aberdeencity.gov.uk/online-applications/search.do?action=simple&searchType=Application>

A **Section 75 Agreement** has been completed and registered relative to the proposed conversion of Ruby House to residential accommodation. This requires the developer to contribute the sum of £1997.09 per unit to Aberdeen City Council for the delivery of Community Facilities, Core Paths, Healthcare and Open Space.

The site is within the City Centre Conservation Area.

TENURE

The Heritable Interest in Ruby House is being offered for sale with Vacant Possession.

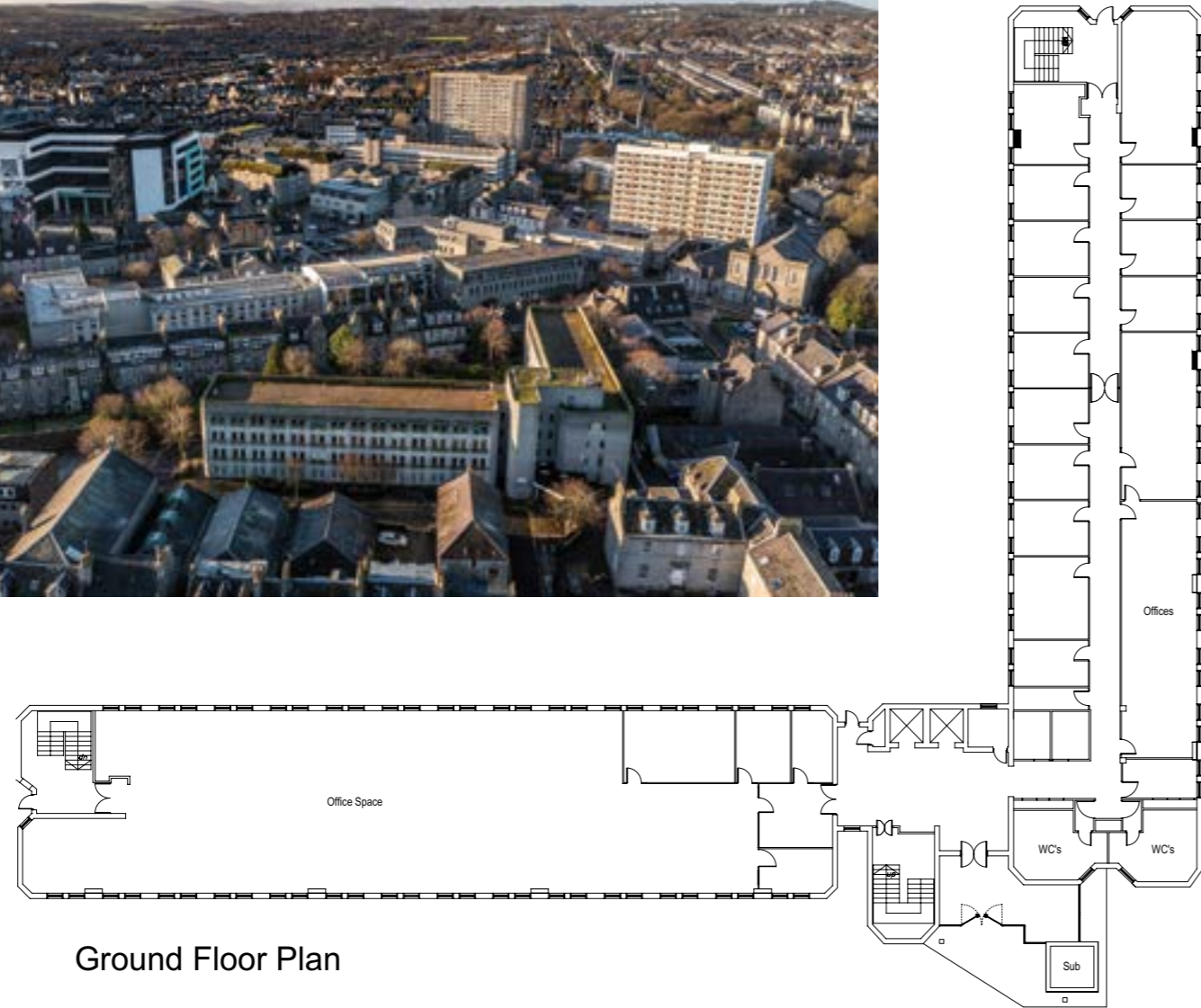

Ground Floor Plan

Proposed Site Layout Plan







PRICE

Offers are invited for our client's heritable interest.

METHOD OF SALE / FURTHER INFO

Please contact the selling agent for details on offering requirements and further information available to interested parties.

CONTACT

For further information please contact:

Niall Macleod

niall.macleod@savills.com
+44 (0) 1224 971 132

Claire Crawford

claire.crawford@savills.com
+44 (0) 796 755 5881

Mark McQueen

mark.mcqueen@shepherd.co.uk
+44 (0) 7920 492448



IMPORTANT NOTICE

Maps are reproduced from the Ordnance Survey Map with the permission of the Controller of H.M. Stationery Office. © Crown copyright licence number 100022432 Savills (UK) Ltd, and published for the purposes of identification only and although believed to be correct accuracy is not guaranteed.

Savills, their clients and any joint agents give notice that:

1. They are not authorised to make or give any representations or warranties in relation to the property either here or elsewhere, either on their own behalf or on behalf of their client or otherwise. They assume no responsibility for any statement that may be made in these particulars. These particulars do not form part of any offer or contract and must not be relied upon as statements or representations of fact.
2. Any areas, measurements or distances are approximate. The text, photographs and plans are for guidance only and are not necessarily comprehensive. It should not be assumed that the property has all necessary planning, building regulation or other consents and Savills have not tested any services, equipment or facilities. Purchasers must satisfy themselves by inspection or otherwise.

Designed and Produced: 231115 NM/CC