

Key to Low Level Services

- HATCHED SYMBOL INDICATES NEW OR RELOCATED FITTING
- DADO TRUNKING
 - △ FUSED SPUR (UNSWITCHED)
 - LETTERS INDICATE FUSE FUNCTION
 - FRIDGE
 - DISHWASHER
 - WATER HEATER
 - WATER FILTER
 - LIGHT RELAY TO KITCHEN UNITS
 - ⏏ SOCKET OUTLET - NUMBER OF SOCKETS INDICATED
 - ⏏ SWITCHED SOCKET - NUMBER OF SOCKETS INDICATED
 - ⏏ DATA POINT - NUMBER OF RJ45s INDICATED
 - ⏏ FLOOR BOX - TEXT INDICATES POWER AND DATA POINTS
 - ⏏ CLEANERS SOCKET
 - ⏏ FLOOR GROMMET
 - ⏏ SWITCHED FUSED SPUR
 - LED SPOT LIGHTS POSITIONED ON THE RAISED FLOOR SIDE PANEL

ELECTRICAL PLAN NOTES

ALL DOUBLE SWITCH SOCKET OUTLETS TO CONFORM TO DBA REGULATIONS 400mm TO THE UNDERSIDE OF THE SOCKET FROM PFL & 300mm TO THE CORNER OF THE WALL UNLESS STATED OTHERWISE

LIGHT SWITCHES BETWEEN 800mm & 1100mm FROM PFL UNLESS STATED OTHERWISE



Please refer to finishes schedule REF: L13

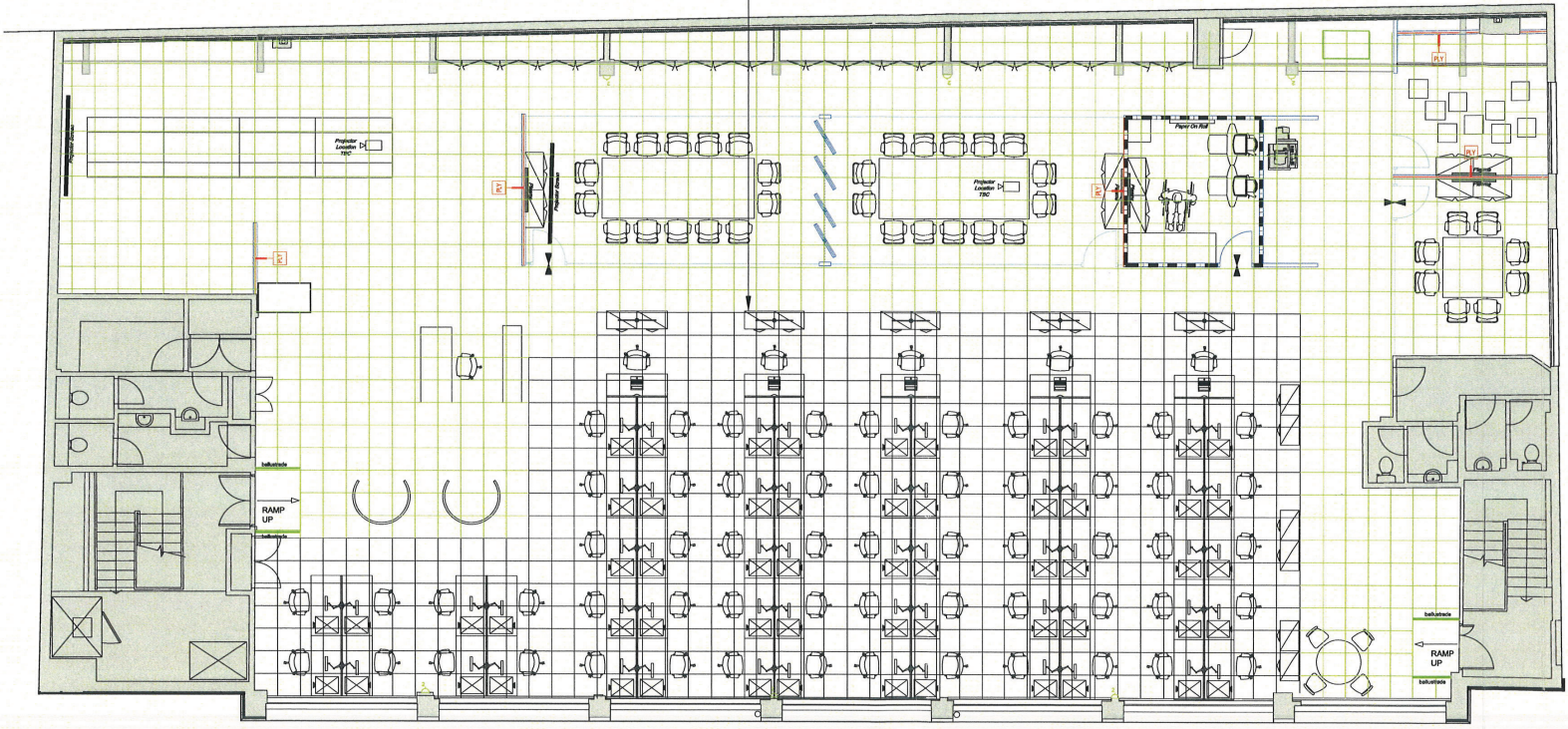

A 09/08/11 New raised floor 7 ramps added JP
 Rev. Date: Description Drawn
 Revisions:

London Office:
3rd Floor, 27-32 Old Jewry,
London, EC2R 8DQ
Tel: +44 (0) 20 7776 2888

Liverpool Office:
The Corn Exchange,
Farnwick Street, Liverpool L2 7UL
Tel: +44 (0) 151 222 0159

www.dentonassociates.com

Project Title: **FOR COMMENT**
Billington Cartmel
7-9 Heathmans Road
Parsons Green
London

Drawing Title:
Low Level Layout

Drawn By: SB Date:

Scale: 1:100 @ A2 Checked By:

Job No: 7264 LL Dwg type: 1 Level: A Revision: