

notes
 Do not scale from this drawing. All dimensions are to be checked on site. Any discrepancies must be reported to the Designer immediately. Proposals are subject to approvals by statutory authorities.

**CROSS SECTION OF MEZZANINE
 BALUSTRADE**
 NTS

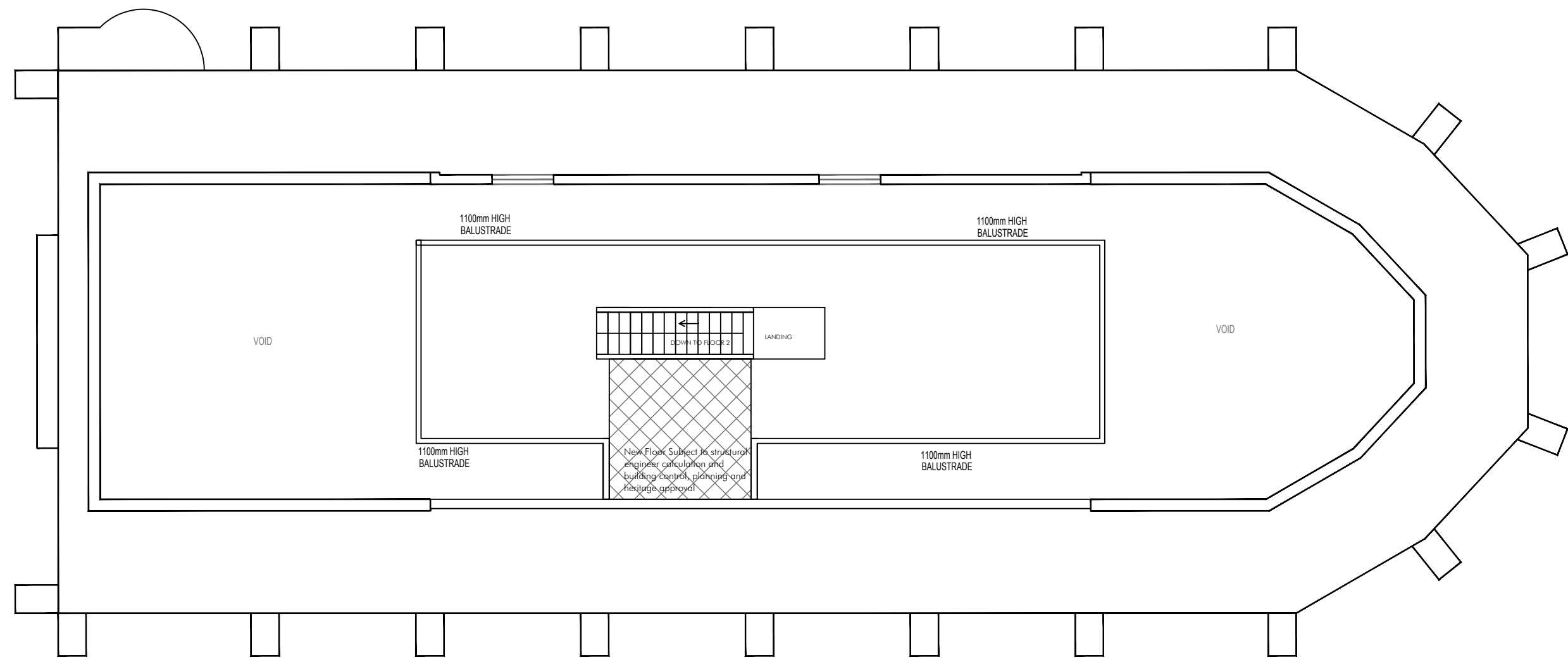
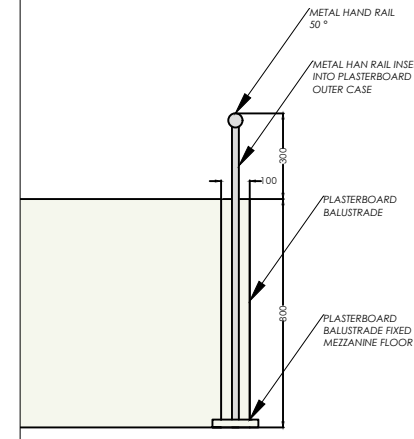

rev	date	note	by	checked

ORCHARD

Orchard House, Threshelfords Business Park, Inworth Road, Feering, Essex, CO5 9SE
 T: 020 7061 9866 | F: 020 7061 9877
 E: info@orchardgroup.org.uk | W: www.orchardgroup.org.uk

client
THE CHAPEL

project
 THE CHAPEL
 JOHN ARCHER WAY
 LONDON

drawing
 THIRD FLOOR
 PROPOSED GA &
 BALUSTRADE CROSS SECTION

drawing no
OG17-053

date	job no	revision	scale	drawn	checked
23/05/18	OG17-053 C		1:100@A3 CC		AC

Orchard Group ©
 Copyright of this drawing is held by Orchard. It is issued on the condition that it is not copied, reproduced or disclosed to any third party without written consent from Orchard.