

This drawing is the copyright of Tomes Architects and may not be copied, altered, or reproduced in any way, or be passed to a third party without our written authority.  
 All dimensions are to be checked on site before commencing work. Any discrepancies should be reported to the project manager immediately.

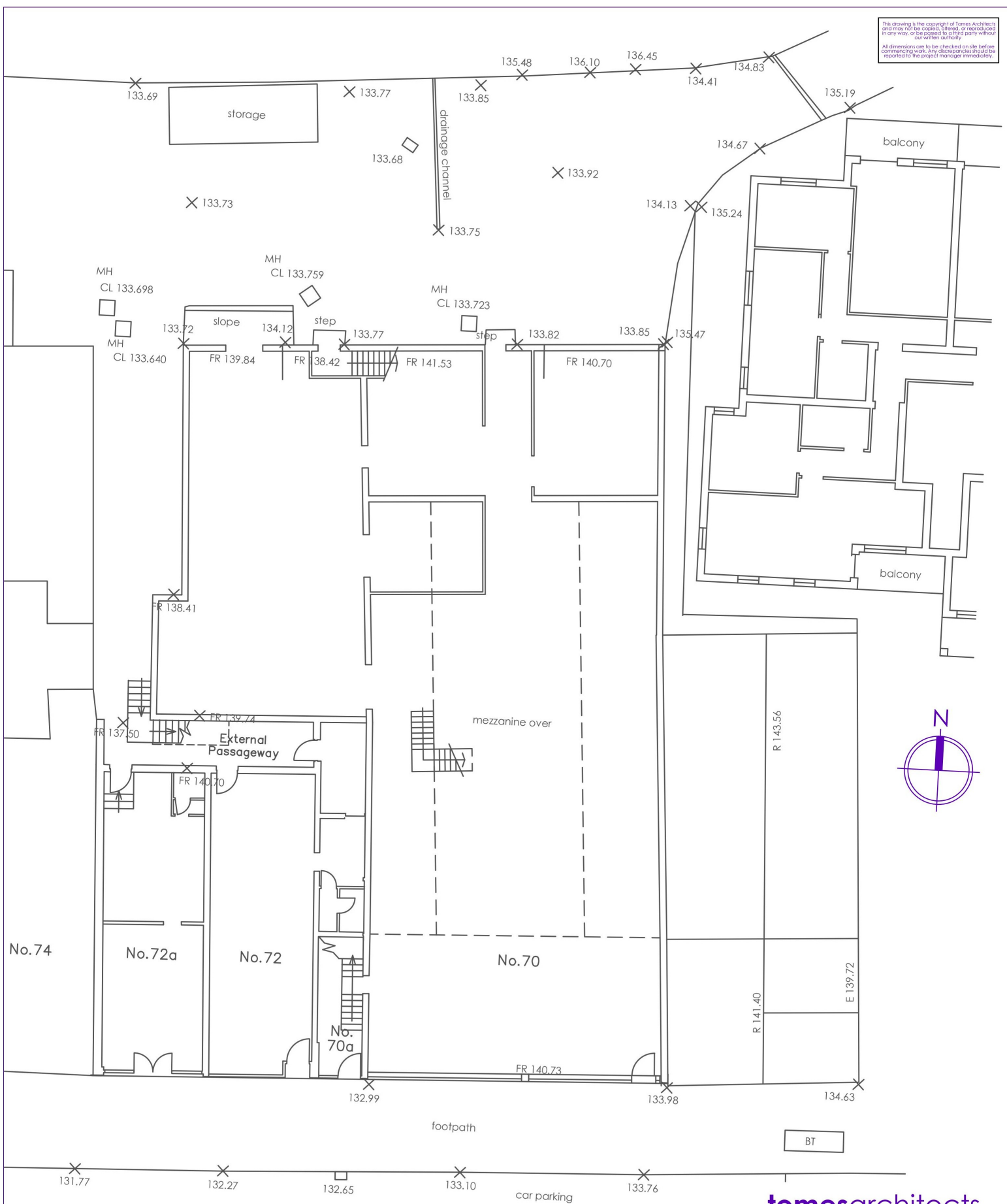

Scale Bar 1:200 (Metres)



# Existing Indicative Ground Floor

Information taken from previous planning applications and other sources within the public realm and should be treated as purely indicative only.

**tomesarchitects**  
 architecture + project management

the old rectory, 108 london road, widley, hampshire, po7 5aa  
 tel: 023 9309 2307 email: info@tomesarchitects.co.uk

project	70/70A Wey Hill Haslemere	date	17 Feb 2022
drawing	Existing Ground Floor	scale	1:200@A4
drawing no.	<b>C3492-1</b>	revision	