

Up to 183,868 sq ft of Office Space

Situation & Location

Frimley Square is situated to the north of Frimley town centre, an affluent town in Surrey, located 33 miles from Central London. Reading is located 21 miles north-west and Guildford 12 miles south-east.

AVAILABLE TO LET

Description

- Four self-contained office buildings totalling 183,868 sq ft.
- Individual office buildings ranging between 27,714 – 59,165 sq ft arranged around central plaza.
- Well connected - 1 mile from the M3 motorway (Junction 4) with Frimley Rail Station approx. 1 mile to the south-west, providing regular services to London Waterloo, Guildford and Reading.

Property Features

- Flexible floor plates
- Air conditioning
- Suspended ceilings
- Fully accessible raised floors
- Reception(s) with breakout space
- Dedicated male and female WCs
- Shower/changing accommodation
- 2x passenger lifts in each building (except B1 which has 1)
- Bike racks
- 642 car parking spaces (1:286 sq ft)
- EPC C across all buildings.

Availability

- Available via new lease(s).

Occupational Costs

QUOTING RENT	Upon Application
RATES	c. £10.00 per sq ft
SERVICE CHARGE	TBC

For more information, please contact:

James Goodwin

077176 52803

James.Goodwin@cushwake.com

Cameron Lineen

078276 61335

Cameron.Lineen@cushwake.com

Cushman & Wakefield
43/45 Portman Square

London, W1A3BG

Phone: +44 (0)20 7152 5000

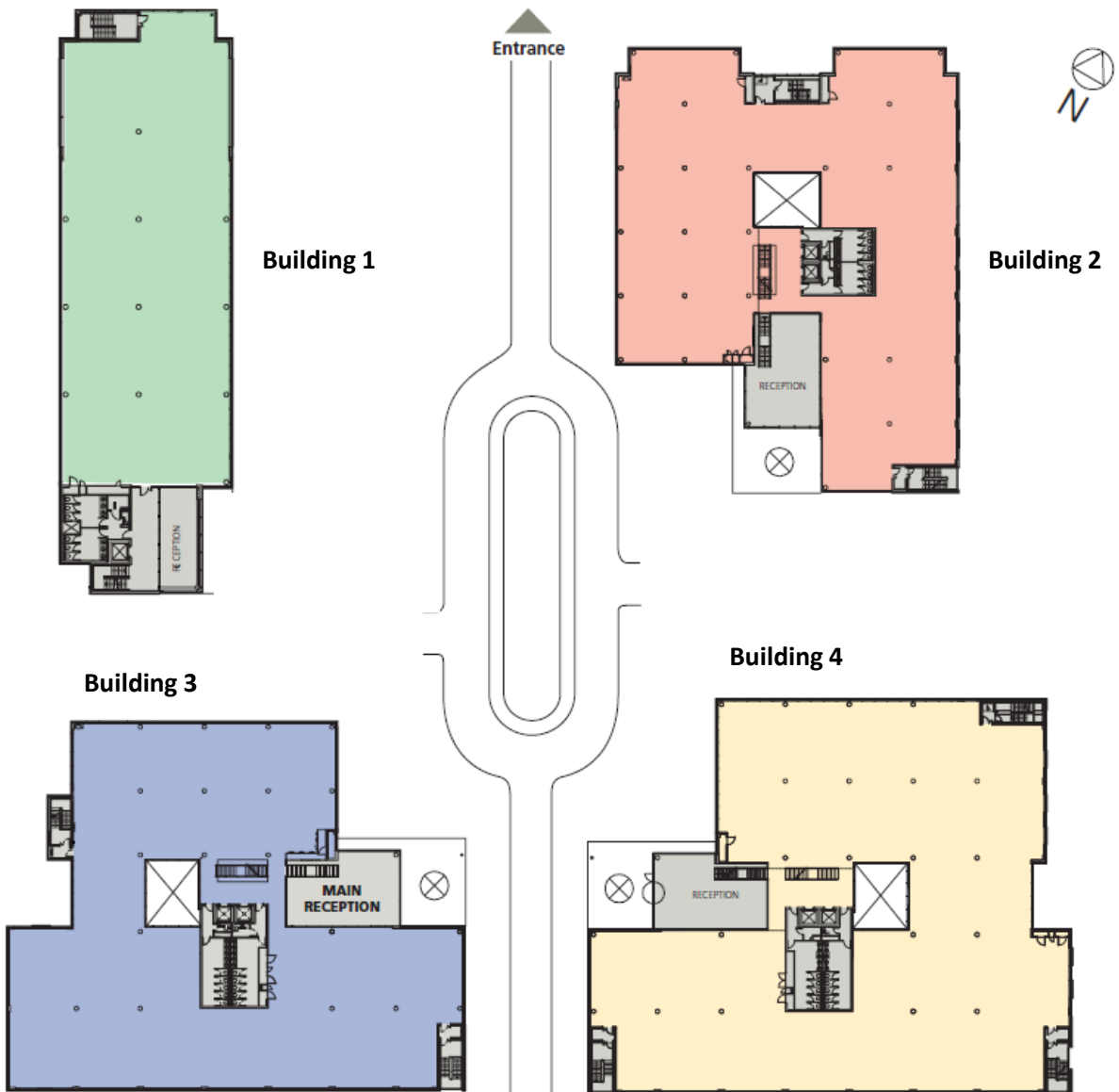

ACCOMMODATION	SQ FT	SQ M	AVAILABILITY
Building 1	27,714	2,574.7	Available to let
Building 2	47,112	4,376.9	Available to let
Building 3	49,876	4,633.6	Available to let
Building 4	59,165	5,496.6	Available to let
Total	183,868	17,081.9	



OFFICE SPACE FOR LEASE

Frimley Square
Frimley, GU16 8QD

