



*UP TO 57,000 SQ FT OF NEW OFFICES
NEXT TO MARBLE ARCH WITH VIEWS
OVER HYDE PARK*

Coming Q3 2022





Summary Specification

- Brand new Grade A offices
- Designed by AHMM
- BREEAM 'Excellent'
- 150mm raised access flooring
- Four pipe fan coil air conditioning
- Fresh Air Flow Rate 1.65l/s per m²
- 3.26 m floor to soffit ceiling height
- Exposed services with hybrid raft ceiling system
- Office occupational density 1:8 sqm
- Terraces on floors 6, 7 and 8
- 3 x 24 person passenger lifts
- 121 cycle spaces, 10 showers, 154 lockers and drying room
- Ground floor café
- Openable windows providing the opportunity for mixed mode operation

Typical Floorplan

Floor 5 8,353 sq ft | 776 sq m

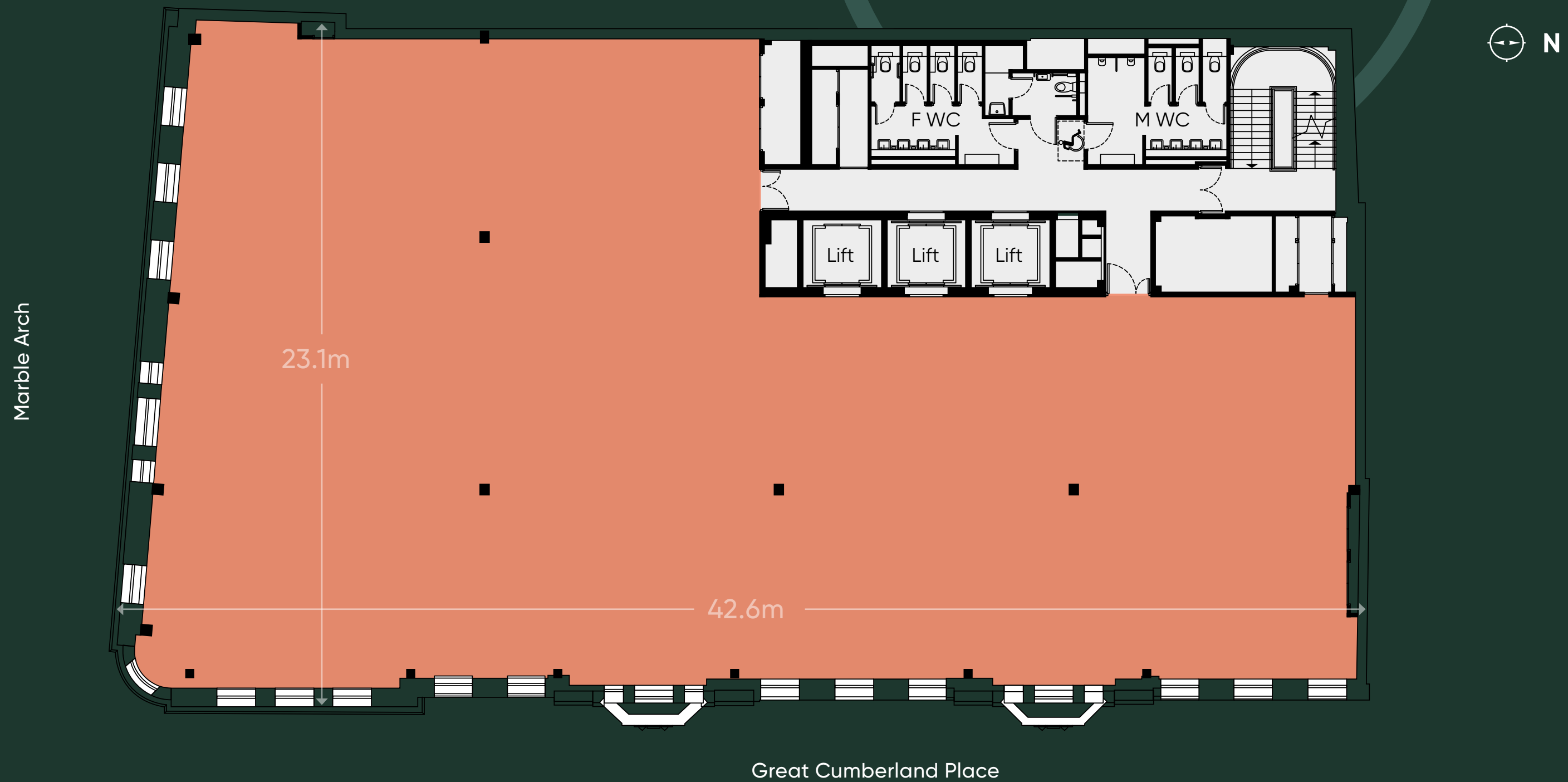

Accommodation Schedule

Floor	Use	Sq ft	Sq m	Terrace Sq ft
08	Office	5,207	484	635
07	Office	7,586	705	226
06	Office	8,119	754	95
05	Office	8,353	776	
04	Office	8,384	779	
03	Office	8,371	778	
02	Office	8,393	780	
01	Office	3,013	280	
G	Reception & café	1,905	177	
Total		59,331	5,511	956

Please contact the joint agents for more information:



Adam Cosgrove
adam.cosgrove@cbre.com
020 7182 2447
07500 872 851

Richard Smart
richard.smart@cbre.com
020 7182 2577
07956 076 942



Ed Arrowsmith
ed.arrowsmith@cushwake.com
020 7152 5964
07736 869 320

Andy Tyler
andy.tyler@cushwake.com
020 7152 5250
07973 836 236

A development by



www.portmanestate.co.uk

onegreatcumberland.com

IMPORTANT NOTICE RELATING TO THE MISREPRESENTATION ACT 1967 AND THE PROPERTY MISDESCRIPTIONS ACT 1991 CBRE and Cushman & Wakefield on behalf and for the lessors of this property whose agents they are, give notice that: The particulars are set out as a general outline only for guidance of intending lessees and do not constitute, nor constitute part of, an offer or contract. October 2021. SUBJECT TO CONTRACT

Approx NIA measured off architects plans.