



EST 2019

THE STILL'S

— EC1 —

76-86 Turnmill St, London
EC1M 5QU

2x E CLASS UNITS TO LET:
1,561 sq ft and 2,556 sq ft

[LINK TO STREET VIEW](#)



THE SPACE

Hawkins\Brown Architects have undertaken a comprehensive refurbishment, transforming the building with a new façade and around 45,000 sq ft of office and retail space.

VIRTUAL TOUR - Unit 1

VIRTUAL TOUR - Unit 2

UNIT	FLOOR	SQ FT	SQ M
1	Ground	1,561	145
UNIT 1 TOTAL		1,561	145
2	Ground	2,556	238
UNIT 2 TOTAL		2,556	238
TOTAL		4,117	383



Front elevation looking north along Turnmill Street

FLOOR PLANS

Ground Floor

Unit 1
1,561 sq ft / 145 sq m

Unit 2
2,556 sq ft / 238 sq m

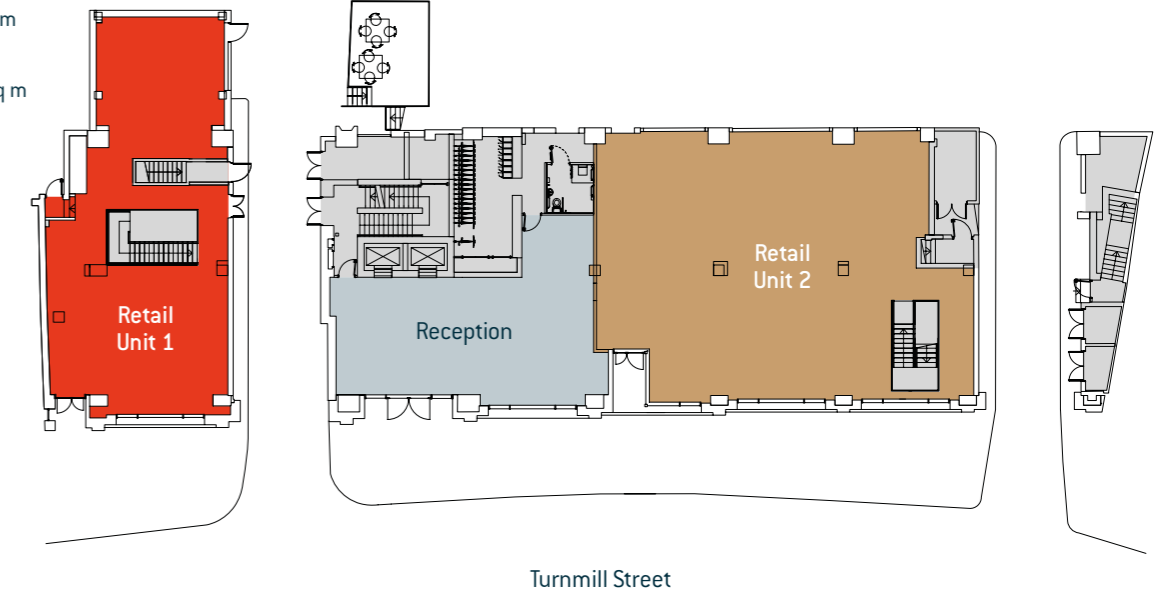

- Retail Unit 1
- Retail Unit 2
- Core

For indicative purposes only. Not to scale.



The Space

THE AREA

Farringdon continues to attract occupiers from many sectors and continues to be the home of many of the key names in the creative industry – thanks in part to its diverse amenity offering.



1

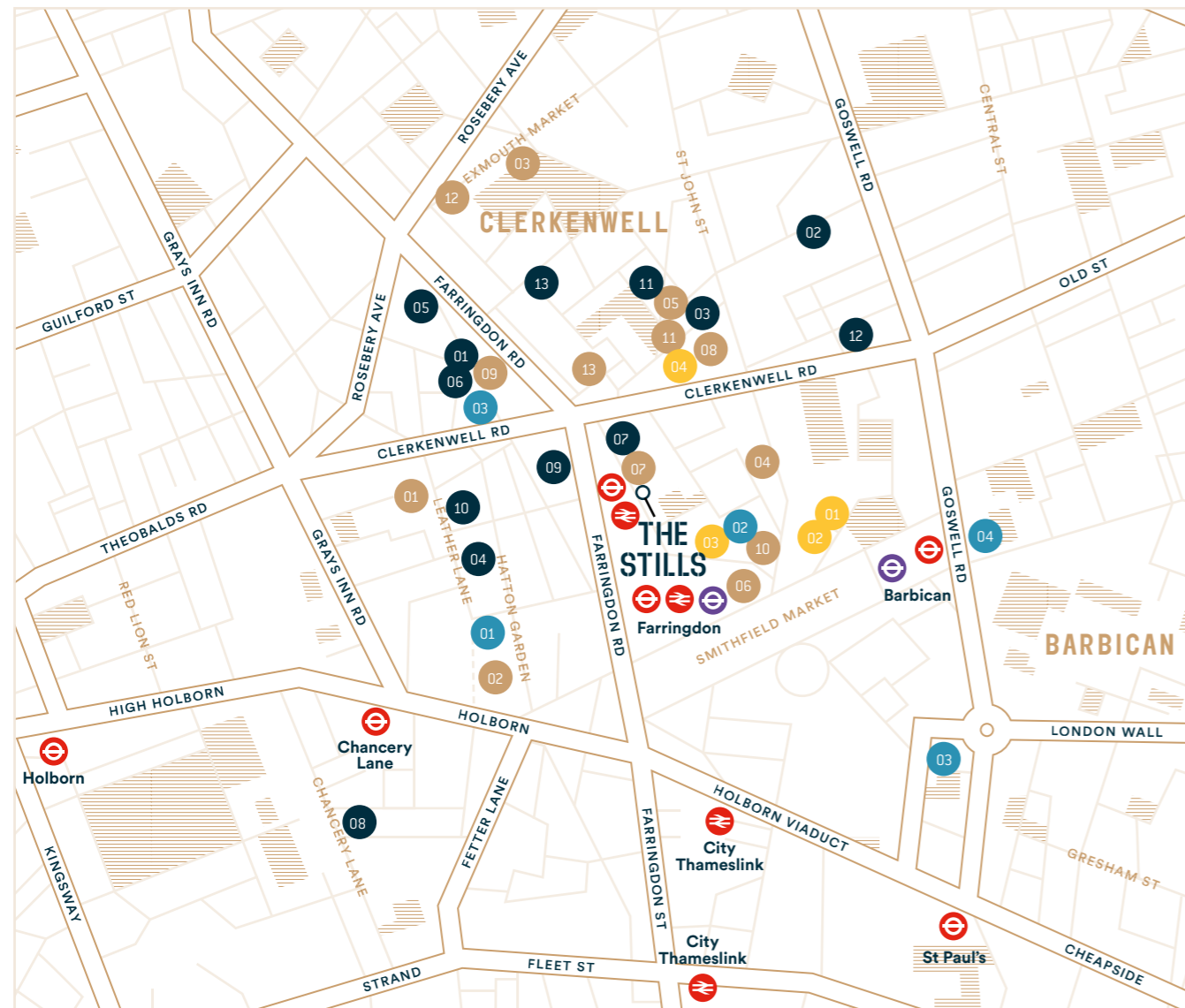

Local Occupiers

- 01 Adidas
- 02 Airbnb
- 03 Deloitte Digital
- 04 Grey London
- 05 LinkedIn
- 06 Moonpig
- 07 Publicis Groupe
- 08 Saatchi & Saatchi
- 09 Steelcase
- 10 TM Lewin
- 11 Unilever Plc
- 12 Vitra
- 13 Zaha Hadid

Bars & Restaurants

- 01 Attendant
- 02 Bounce
- 03 Coin Laundry
- 04 Foxlow
- 05 Granger & Co
- 06 Hix Oyster & Chop House
- 07 Ibérica
- 08 Modern Pantry
- 09 Piano Works
- 10 Polpo
- 11 Sushi Tetsu
- 12 The Exmouth Arms
- 13 The Green

Hotels

- 01 Malmison
- 02 The Fox & Anchor
- 03 The Rookery
- 04 The Zetter Hotel

Fitness

- 01 Gymbox
- 02 F45 Training
- 03 PureGym
- 04 Virgin Active

- 1 Polpo
- 2 Foxlow
- 3 Malmison

3



2



MORE FOOD
THIS WAY



OUT & ABOUT



1



2



3



EXMOUTH MARKET /
ST JOHN STREET /
COWCROSS STREET /
CLERKENWELL GREEN /
CHARTERHOUSE STREET /

4



Whether it's coffee first thing on the way to work or a swift after-work drink on the way home, Michelin starred chefs to street food favourites, Farringdon and the surrounding area has it covered.

- 1 Vinoteca
- 2 Exmouth Market
- 3 Iberica
- 4 Cubana
- 5 Bird of Smithfield

5





07

The Stills / 76 Turnmill Street



CONNECTIVITY

Farringdon Station truly is on the doorstep – right across the road. It offers unrivalled travel connections across the city in all directions. The Elizabeth Line also offers dramatically reduced travel times across the City.

-  Walk times from building
-  Journey times via Farringdon Station (Source TfL)
-  Elizabeth Line

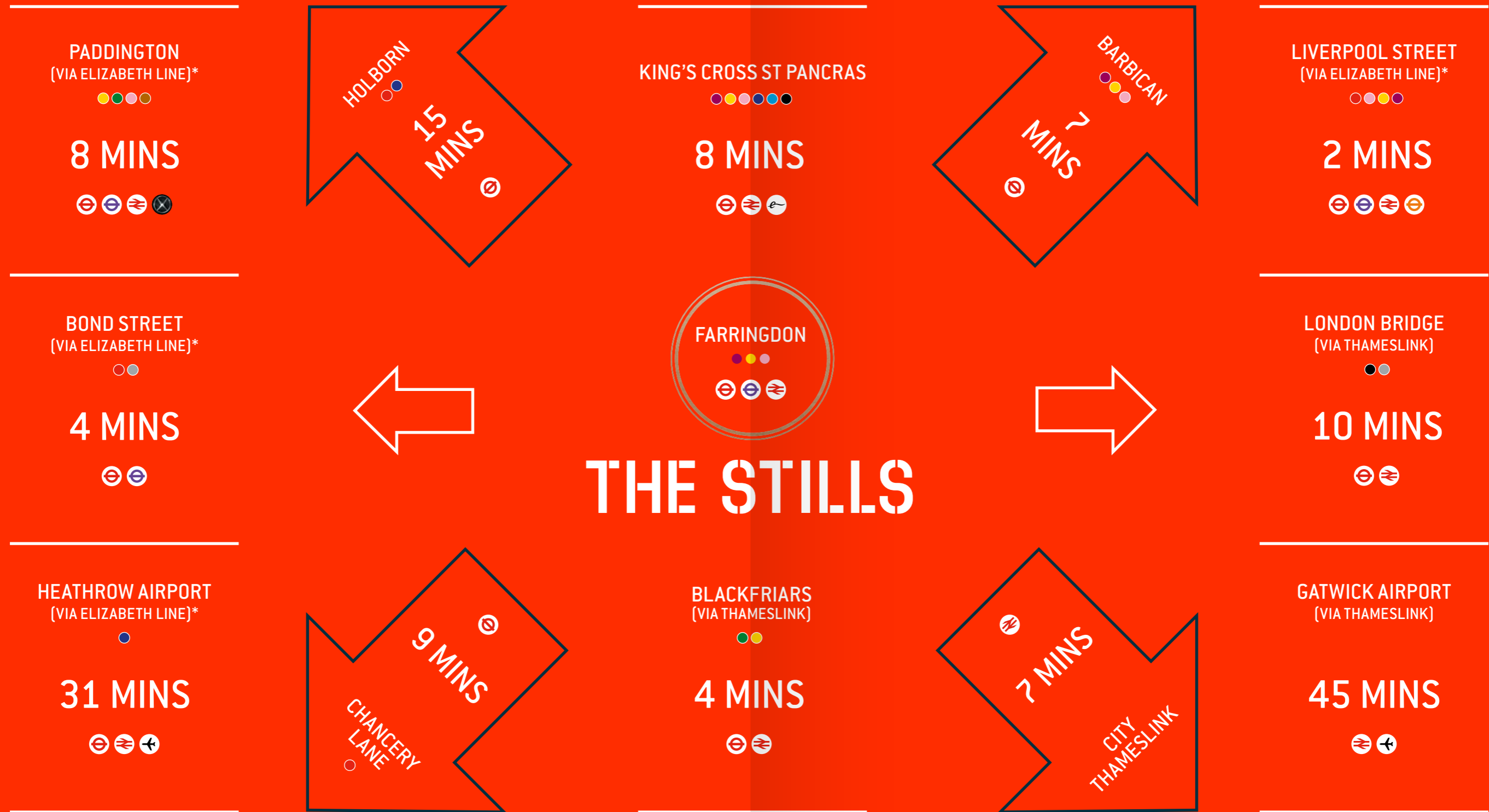



In a historic area for industry and trade, The Stills stands on the original site of the Booth's Gin Distillery. The area was renowned for gin production and was also home to many merchants and engineering and metal-working businesses.

CONTACT

For further information, please contact the sole letting agents:



Abi Thirkell
+44 (0) 7407 128379
Abi.Thirkell@cushwake.com

Matthew Englender
+44 (0) 77814 787 892
Matthew.Englender@cushwake.com

Roshni Patel
+44 (0) 7741 094 974
Roshni.N.Patel@cushwake.com

THESTILLS.CO.UK



All CGI images are for indicative purposes only. Cushman & Wakefield copyright 2019. No warranty or representation, express or implied, is made to the accuracy or completeness of the information contained herein, and same is submitted subject to errors, omissions, change of price, rental or other conditions, withdrawal without notice, and to any special listing conditions imposed by the property owner(s). As applicable, we make no representation as to the condition of the property (or properties) in question. July 2023.

Designed and produced by Cre8te – 020 3468 5760 – cre8te.london