

architecture design limited
 The Fitted Rigging House
 Anchor Wharf
 The Historic Dockyard,
 Chatham, Kent, ME4 4TZ

+44 (0)1634 791166
 www.adesign.ltd
 info@adesign.ltd
 01634 791166

Client: **Adil Group**
 Project: **Wembley Brent House**
 Drawing no: **139.7/18** Status: **Costs Approval**
 Date: **17/10/2023** Time: **13:14**
 Revision: **3** Scale: **1:50@A1**
 Site address: **Wembley Place, 341-345 High Road, Wembley, London, HA9 6AQ**

This document and its design content is copyright ©. It shall be read in conjunction with all other associated project information including models, specifications, schedules and related consultants documents. Do not scale from documents. All dimensions to be checked on site. Immediately report any discrepancies, errors or omissions on this document to the Originator. If in doubt ASK.

Split Unit Proposal

0 1 2 3 4 1:50

Proposed Covers internal: 38
 Proposed Covers external: 12

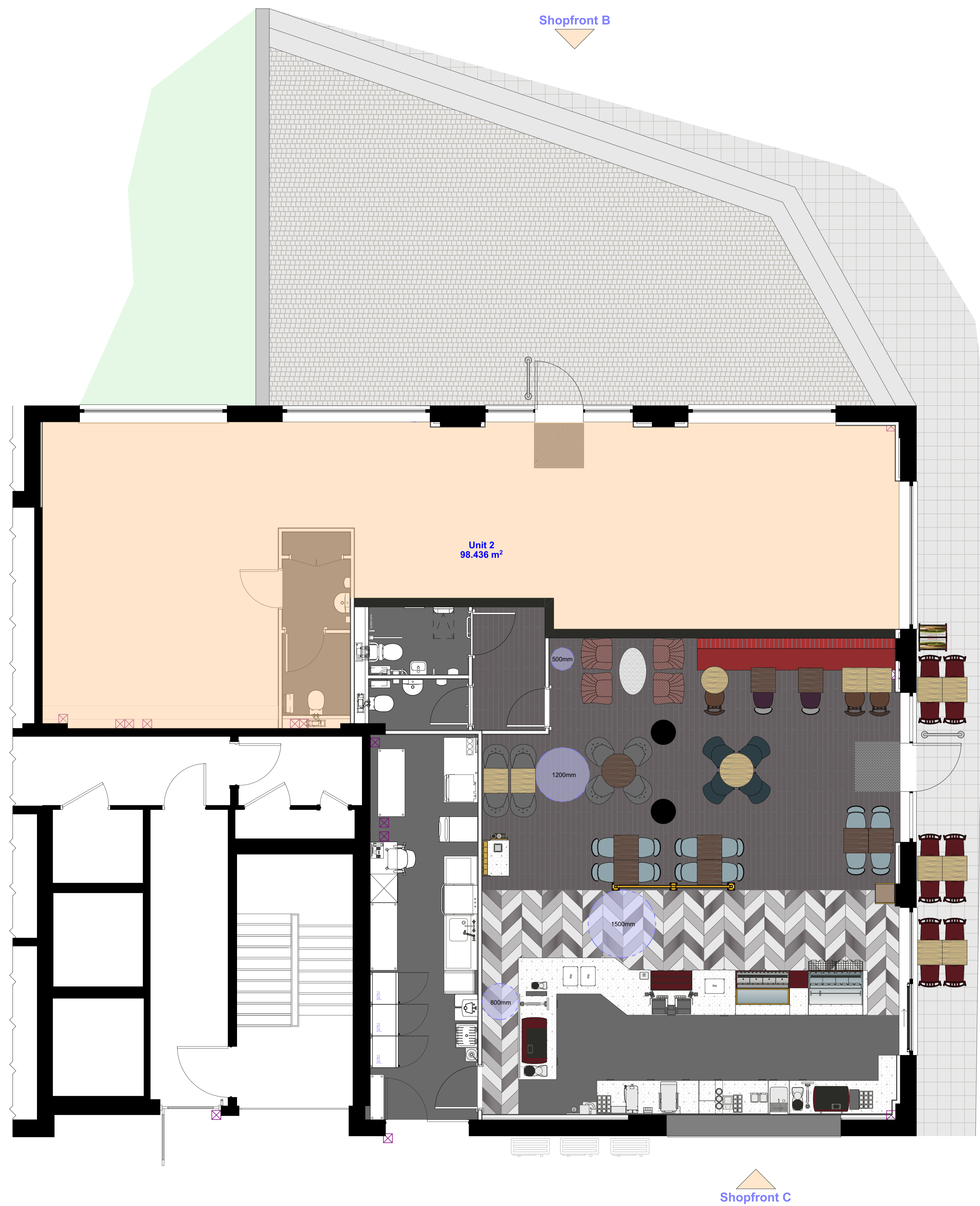

Shopfront B

Shopfront A

Shopfront C

Unit 2
98.436 m²