

FOR SALE

661 UXBRIDGE ROAD,
PINNER,
HA5 3LW



LONG LEASEHOLD BUSINESS UNIT FOR SALE

Former dental surgery (Use Class E) and car park situated in a prominent position in Pinner Green

Key Features

- Pinner Metropolitan Line Station (0.7 miles)
- Hatch End Overground Station (1.7 miles)
- Nearby to Tesco's and other local traders
- Possibility to extend the existing building at ground and first floor subject to planning.

For further information, please contact:

david charles
property consultants

George Moriarty - 020 8429 9003
george@davidcharles.co.uk

29 High Street | Pinner | Greater London | HA5 5PJ
T 020 8866 0001 E info@davidcharles.co.uk
davidcharles.co.uk

FOR SALE

661 UXBRIDGE ROAD,
PINNER,
HA5 3LW



The Property

The property was previously used as a dental surgery, it comprises of an open plan reception area, a decontamination room, two dental surgery clinics, a toilet and a small kitchenette.

To the front of the property there is a large forecourt with space for approx. 4 vehicles.

Location

The property is located in a prominent position at the intersection of Pinner Green & Uxbridge Road thus in close proximity to Pinner and Hatch End High Streets. The unit benefits from a high level of passing traffic whilst also being within close proximity to Tesco's and nearby to other local traders. Pinner Metropolitan Line Station is 0.7 miles from the property.

Floor Areas

355.21 sqft

Price

£300,000.00 for the long leasehold interest

Viewings

Strictly through appointments with joint sole agents :-

George Moriarty

T: 020 8429 9003

E: george@davidcharles.co.uk

Lily O'Donnell

T: 020 8429 9009

E: lily@davidcharles.co.uk

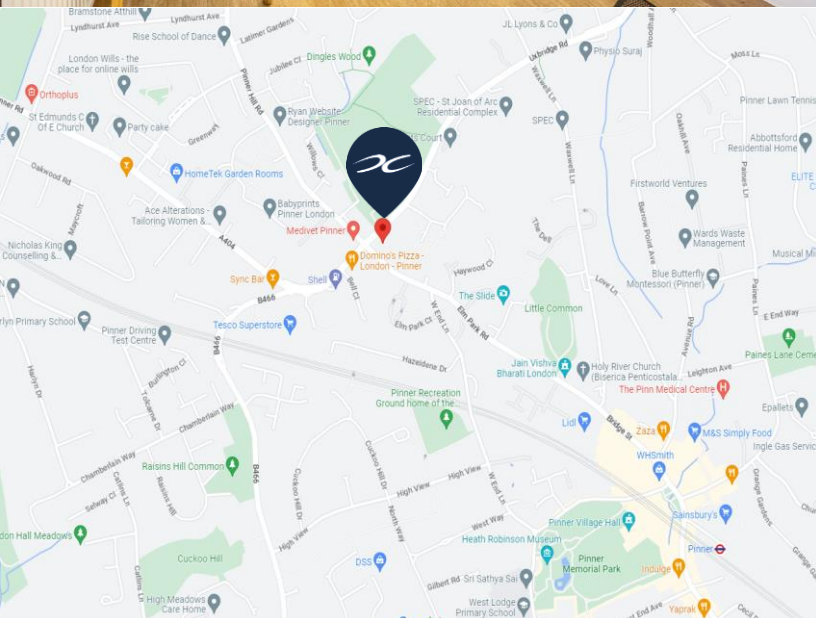

FOR SALE

661 UXBRIDGE ROAD,
PINNER,
HA5 3LW



FOR SALE

661 UXBRIDGE ROAD,
PINNER,
HA5 3LW

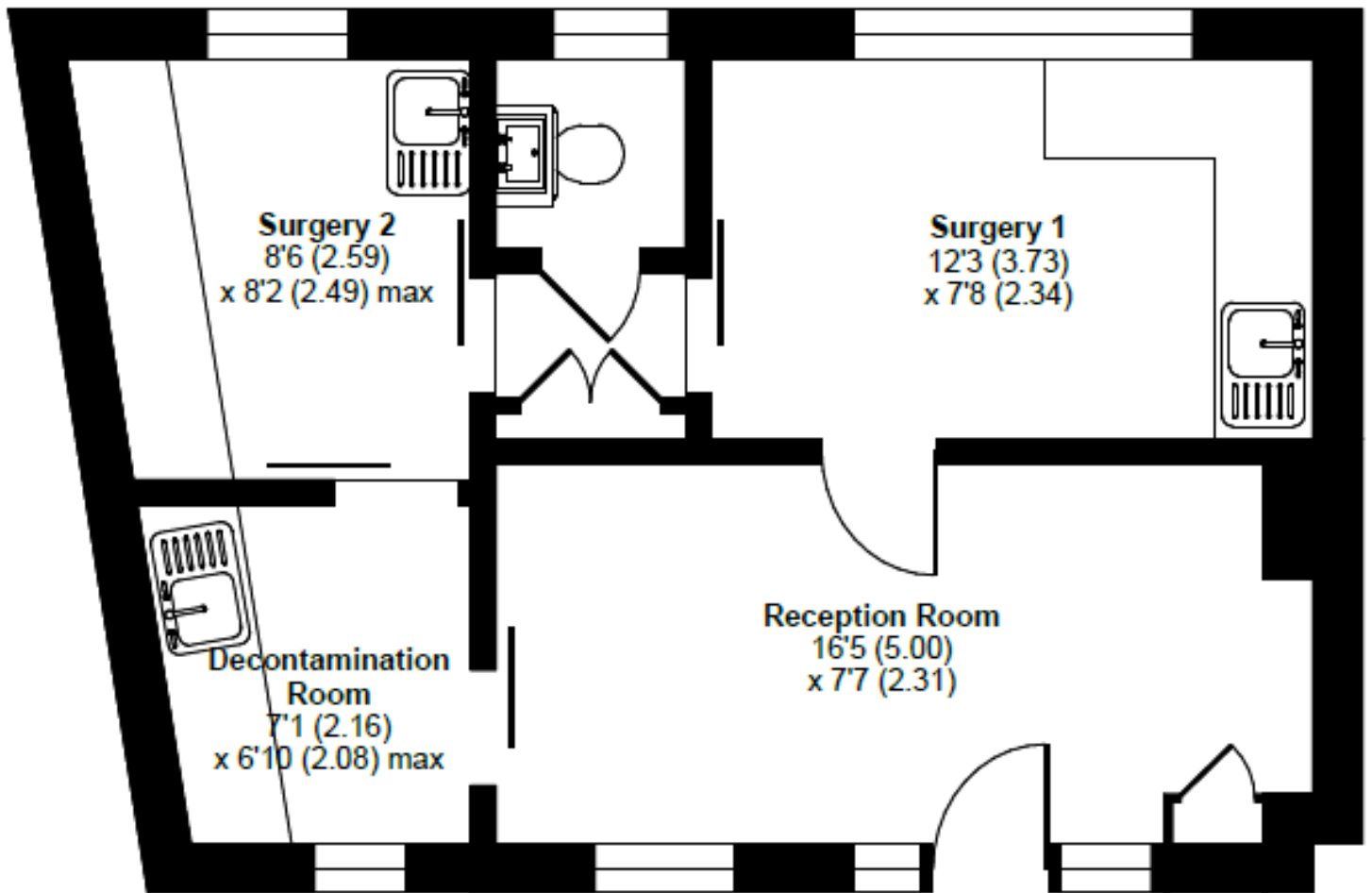

GROUND FLOOR