

DM HALL

To Let
Office

Ground Floor,
Old Canvas Works,
High Street,
Kirkcaldy KY1 2QT



1,836.60 SQ M
GIA (19,769 SQ FT)

Property Details

- Flexible open plan space suitable for various uses subject to planning consent
- Ground floor GIA 1,836.60 sq m (19,769 sq ft)
- Close to amenities and good road transport links
- On site parking
- £71,000 per annum exclusive

LOCATION:

Kirkcaldy is one of Fife's principal centres having a population approaching 50,000 people and a catchment area estimated to be in the region of 150,000. The town benefits from an excellent transportation system, having a railway station located on the east coast mainline, which runs from London Kings Cross via Edinburgh to Aberdeen and the East Fife Regional Road providing a first-class dual carriageway link into Central Scotland's motorway network.

DESCRIPTION:

The subjects under report comprise the ground floor of a substantial three storey traditional building of stone and brick construction. The ground floor is open plan and provides a flexible space suitable for a variety of uses, subject to planning consent. The floors are of solid construction.

The mezzanine floor is accessed by an open trad steel staircase as well as a disabled lift. Services include gas, electricity, mains water and drainage, separate male, female and disabled WC facilities.



Property Details

ACCOMMODATION & FLOOR AREAS :

The property has been measured in accordance with RICS Code of Measuring Practice - 6th Edition on a gross internal basis and is as follows:

Main Building

Ground Floor 1,532.10 sq m (16,492 sq ft)

RATEABLE VALUE:

According to the Scottish Assessors' Association website, the subjects are noted to have an annual Rateable Value of:

£175,000

LEASE TERMS:

Lease offers of £71,000 exclusive are invited on a 12-month basis.

LEGAL COSTS:

Each party will be responsible for paying their own legal costs incurred in any transaction.

VAT:

All prices quoted are exclusive of VAT.

VIEWING ARRANGEMENTS:

Strictly by contacting the sole letting agents.

DM HALL



Regulated by
RICS

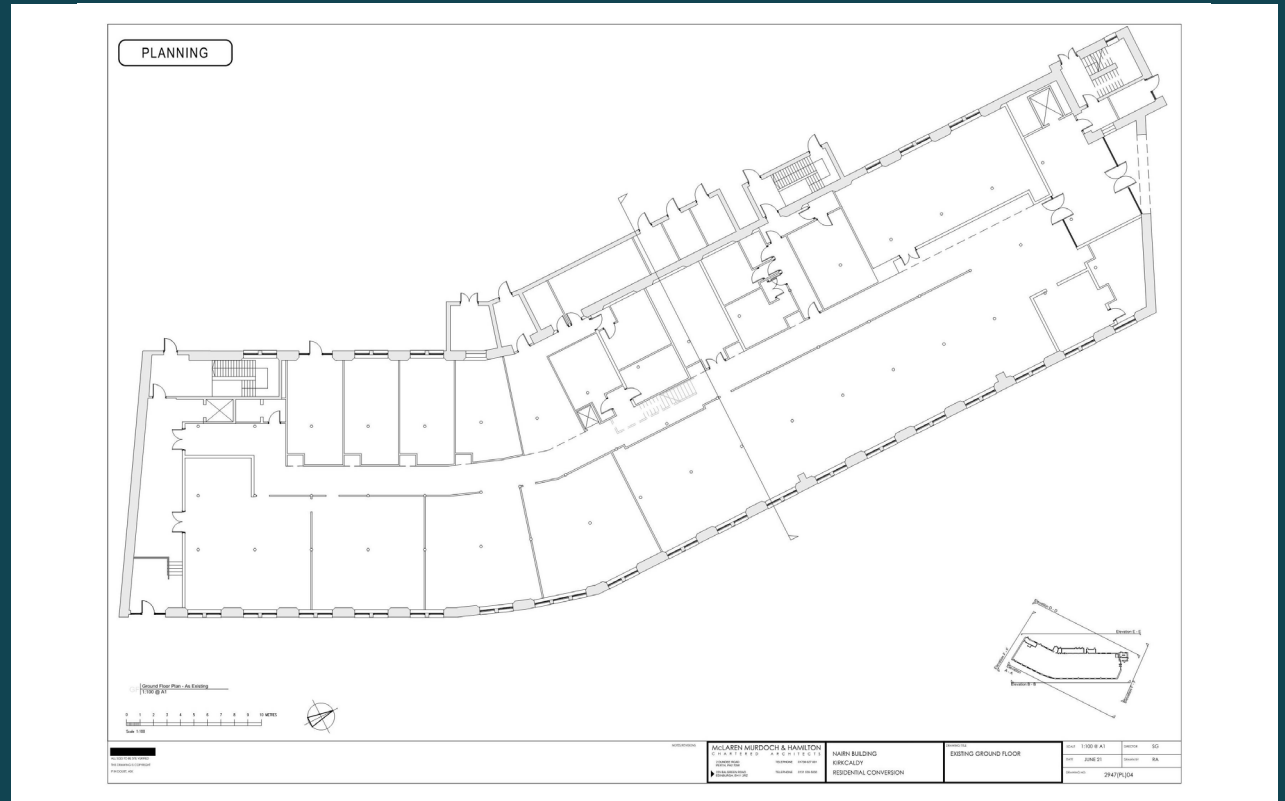

Make an enquiry

Lois Paterson

fifeagency@dmhall.co.uk

DM Hall Commercial Department
27 Canmore Street,
Dunfermline, KY12 7NU

01383 604 100 (Agency Department)

IMPORTANT NOTE: DM Hall for themselves and for the vendors or lessors of this property, whose agents they are, give notice that: (i) The particulars are set out as a general outline only for the guidance of intended purchasers or lessees and do not constitute, nor constitute part of, an offer or contract. (ii) All descriptions, dimensions, reference to condition and necessary permissions for use and occupation, and other details are given without responsibility and any intended purchasers or tenants should not rely on them as statement or representation of fact but must satisfy themselves by inspection or otherwise as to the correctness of each of them (iii) No person in the employment of DM Hall has any authority to make or give any representation or warranty whatever in relation to the property. (iv) All prices, premiums and rents quoted are exclusive of VAT. (v) The information contained in these particulars has been checked and, unless otherwise stated, it is understood to be materially correct at the date of publication. After these details have been printed, circumstances may change outside our control (vi) These particulars are provided for record purposes only and are not intended to create, nor to be relied upon as creating, any contractual relationship or commitment. Any contract shall only be entered into by way of our clients' solicitors.