

9 WILLIAM STREET

Windsor, SL4 1BB

HORIZON CODE: 593

Ground Floor
Internal Area Plan

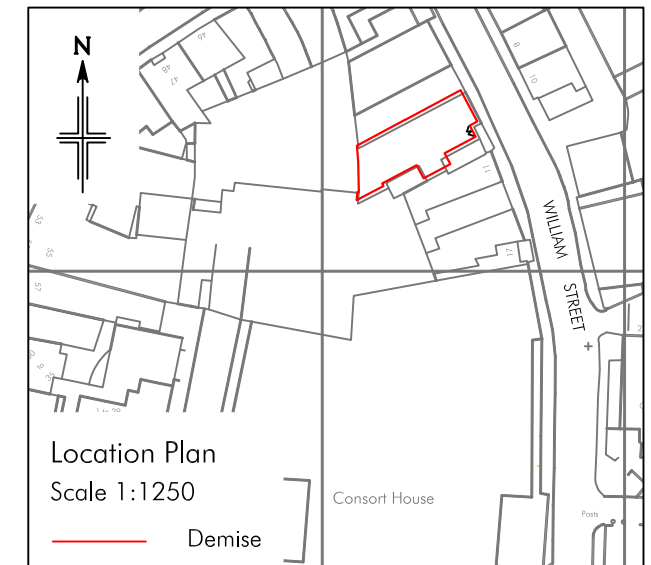

NOTES

This drawing complies with the 6th edition of the RICS code and is produced to an accuracy commensurate with standard presentation scales. It is held in a scaled digital CAD format.

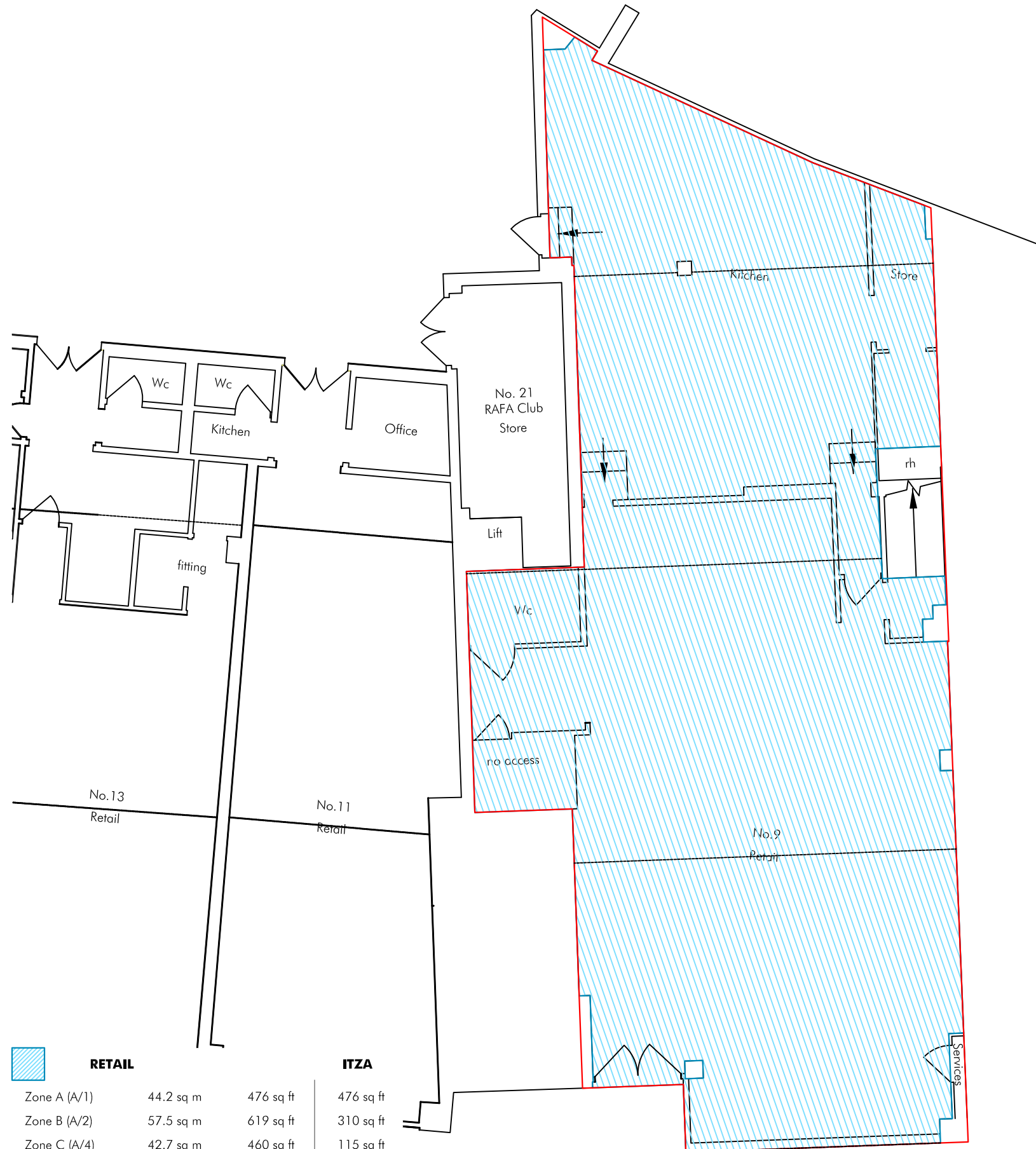

RETAIL		ITZA	
Zone A (A/1)	44.2 sq m	476 sq ft	476 sq ft
Zone B (A/2)	57.5 sq m	619 sq ft	310 sq ft
Zone C (A/4)	42.7 sq m	460 sq ft	115 sq ft
Zone D (A/8)	23.6 sq m	254 sq ft	32 sq ft
Remainder (A/16)	0.0 sq m	0 sq ft	0 sq ft
RETAIL AREA:	168.0 sq m	1809 sq ft	933 sq ft

 **GROSS INTERNAL AREA**

TOTAL GIA: 174.1 sq m 1874 sq ft



CBRE Limited, St Martins Court, 10 Paternoster Row,
London, EC4M 7HP
Switchboard: 0207 182 2000 Fax: 0207 182 3007
Web: www.cbre.com

Address:	9 William Street
	Windsor
	SL4 1BB
Drawing:	Internal Area Plan
Date:	29/08/2017
Scale:	1:100@A3
Drawn:	GL/PF
Dwg. No.	0207003-593-WS9-00-NIA
Project No.	207003
Alt. Scale:	
Checked:	AG
Rev.	A