



## TO LET - OFFICE

EDISON HOUSE  
FULLERTON ROAD  
GLENROTHES  
KY7 5QR

- Refurbished Accommodation
- Offices available from 32 – 284 SQ M (345 – 3,059 SQ FT)
- Car parking
- Immediate entry available

**LOCATION:**

Glenrothes is a former New Town and is one of Fife's principal centres of population, occupying a central position within the region and having a resident population of approximately 40,000.

Edison House lies on the north western side of Fullerton Road, approximately ¼ mile from the Preston Roundabout that connects to the A92 and in turn provides access to the Scottish Motorway network.

Occupiers in the vicinity include Lidl, Raytheon Systems, and Spittal Bathrooms and Kitchens.

**DESCRIPTION:**

Edison House comprises a modern single storey office building benefitting from the following:

- Suspended ceilings with integral lighting
- Electric heating
- Toilet facilities
- Car parking

**AVAILABILITY:**

Suite	Size (sq ft)	Rent	Service Charge	Rateable Value*
2	377	£3,000	£1,200	£2,750
3	377	£3,000	£1,200	£2,750
6	377	£3,000	£1,200	£2,750
8	377	£3,000	£1,200	£2,750
10	484	£3,800	£1,550	£3,450
14	345	£2,150	£1,100	£2,450
16	345	£2,150	£1,100	£2,450

\* The level of rates payable is set nationally by the Scottish Government and for the financial year 2023 to 2024 it 49.8p for every £1 of rateable value on properties with a rateable value of less than £51,000. It should be noted that under the terms of the Small Business Bonus Scheme, the property may be eligible for 100% rates relief depending on tenant status. Further information on rates payments is available at [www.saa.gov.uk](http://www.saa.gov.uk)

**ENERGY PERFORMANCE CERTIFICATE:**

The subjects have an EPC rating of G. A copy of the EPC is available on request from the letting agents.

**VAT:**

VAT will be payable on the rent.

**LEGAL COSTS:**

Each party will be responsible for paying their own legal costs incurred in any transaction.

**ENTRY:**

Upon completion of legal formalities.

**FURTHER INFORMATION:**

Strictly by contacting the letting agent:

Lois Paterson

Lois.paterson@dmhall.co.uk

DM Hall LLP

27 Canmore Street

Dunfermline

KY12 7NU

Tel: 01383 604100

**VIEWING:**

Strictly by arrangement with the agents.

Ref: ESA2912

Date of publication: June 2023



# Floor Plan

Layout of the units

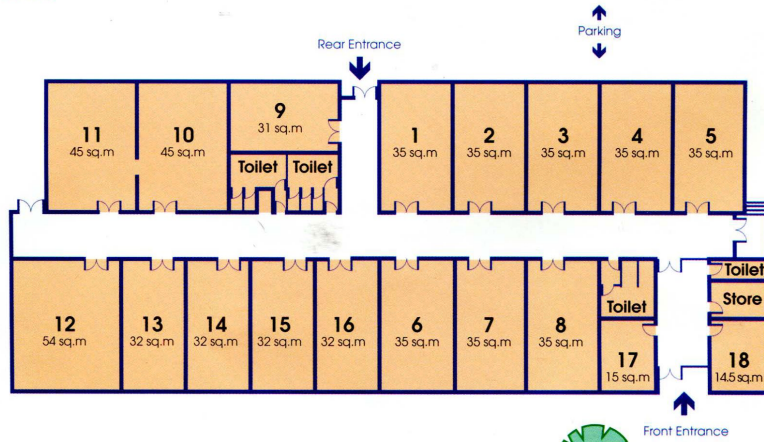

Whilst every effort has been taken to make these particulars as accurate as possible, their absolute accuracy cannot be guaranteed and they do not form any part of a contract.

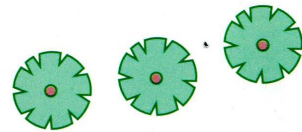

## IMPORTANT NOTE

DM Hall for themselves and for the vendors or lessors of this property, whose agents they are, give notice that:

- (i) The particulars are set out as a general outline only for the guidance of intended purchasers or lessees and do not constitute, nor constitute part of, an offer or contract.
- (ii) All descriptions, dimensions, reference to condition and necessary permissions for use and occupation, and other details are given without responsibility and any intended purchasers or tenants should not rely on them as statement or representation of fact but must satisfy themselves by inspection or otherwise as to the correctness of each of them.
- (iii) No person in the employment of DM Hall has any authority to make or give any representation or warrant whatever in relation to the property.
- (iv) All prices, premiums and rents quoted are exclusive of VAT.
- (v) The information contained in these particulars has been checked and, unless otherwise stated, it is understood to be materially correct at the date of publication. After these details have been printed, circumstances may change outside our control.
- (vi) These particulars are provided for record purposes only and are not intended to create, nor to be relied upon as creating, any contractual relationship or commitment. Any contract shall only be entered into by way of our clients' solicitors.