



INDUSTRIAL / WAREHOUSE UNIT TO LET

## Unit 14 Premier Park, Park Royal, NW10 7NZ

4,655 sq ft (432.46 sq m)

Premier Park is an established, well-managed industrial development located in the heart of Park Royal, one of London's most sought-after industrial and logistics locations.

- Mid terrace industrial/warehouse unit with generous yard & parking
- 6 metres clear height
- One level loading door
- Energy efficient unit with low maintenance costs
- 24-hour on-site security and CCTV
- Excellent access to the A406 North Circular Road (only 400m), the M1 and Central London

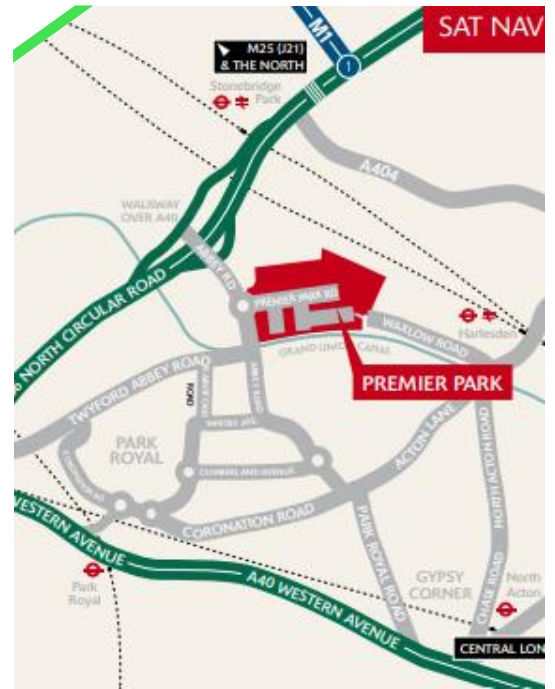
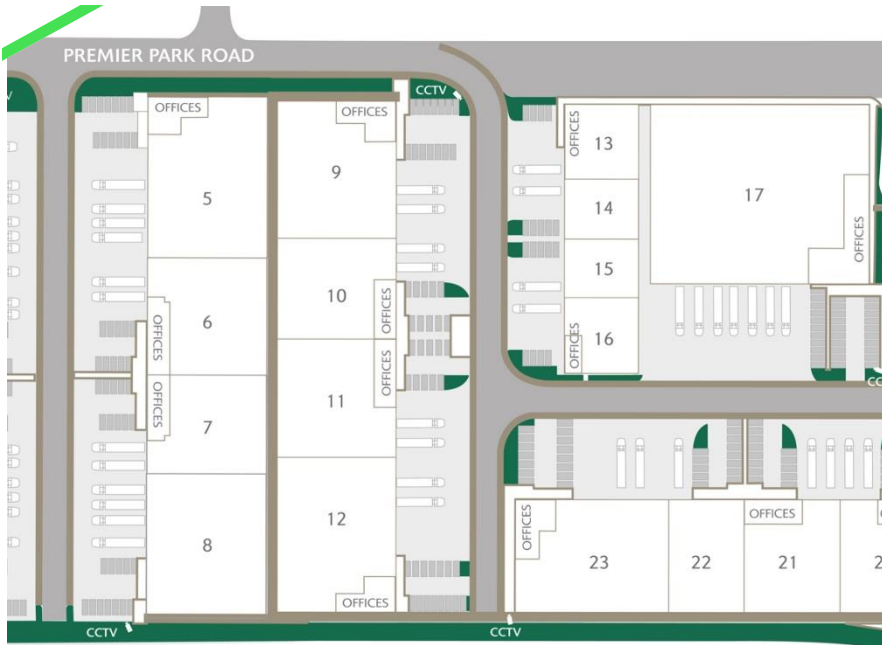

## LOCATION

Premier Park is located to the North West of central London easily accessed from the A40 Western Avenue and A406 North Circular Road. Situated within 400 metres of the A406, the estate fronts Abbey Road, the main route through Park Royal which is London's largest industrial and commercial centre. Major motorway networks can be easily reached including the M1, M40, M4 and the M3 via the M25 London Orbital.

## ACCOMODATION (APPROX) - GEA

UNIT	SQ FT	SQ M
Warehouse	TBC	TBC
Office	TBC	TBC
<b>TOTAL</b>	<b>4,655</b>	<b>432.46</b>

## RENT

On application

## ENERGY PERFORMANCE CERTIFICATE (EPC)

EPC rating available upon request.

## LEGAL COSTS

Each party to bear their own legal costs.

## BUSINESS RATES

Interested parties are advised to make their own enquiries with Local Authority.

## TERMS

The property is available to lease on new FRI lease to be agreed.



## For more information contact:

PARTNER

**ALEX KINGTON**

[Alex.kington@logixproperty.com](mailto:Alex.kington@logixproperty.com)  
07717 704538

SURVEYOR

**CALLUM MOLONEY**

[callum.moloney@logixproperty.com](mailto:callum.moloney@logixproperty.com)  
07815 692996

JOINT AGENTS

**JLL/COLLIER'S**

James Miller/Pat Rosso  
[James.miller@jll.com](mailto:James.miller@jll.com) / [Patrick.rosso@colliers.com](mailto:Patrick.rosso@colliers.com)  
07702 975222 / 07825571048

Misrepresentation Act: All Agents and for the vendors or lessors of this property whose agents they are, give notice that (i) these particulars are produced in good faith, are set out as a general guide only and do not constitute any part of an offer or contract. They are believed to be correct but any intending purchasers or tenants should not rely on them as statements or representations of fact but must satisfy themselves as to the correctness of each of them. (ii) no person in the employment of all agents has any authority to make or give any representation or warranty in relation to this property. February 2023.