

Floor Plans

Unit 6 - 927 sq ft | **Blake Mill Business Park**

 Brue Avenue, Bridgwater, TA6 5LT

Blake Mill Business Park, Unit 6, BS M Direct, Brue Avenue, Bridgwater
Approximate Gross Internal Area
1059 Sq Ft/98 Sq M

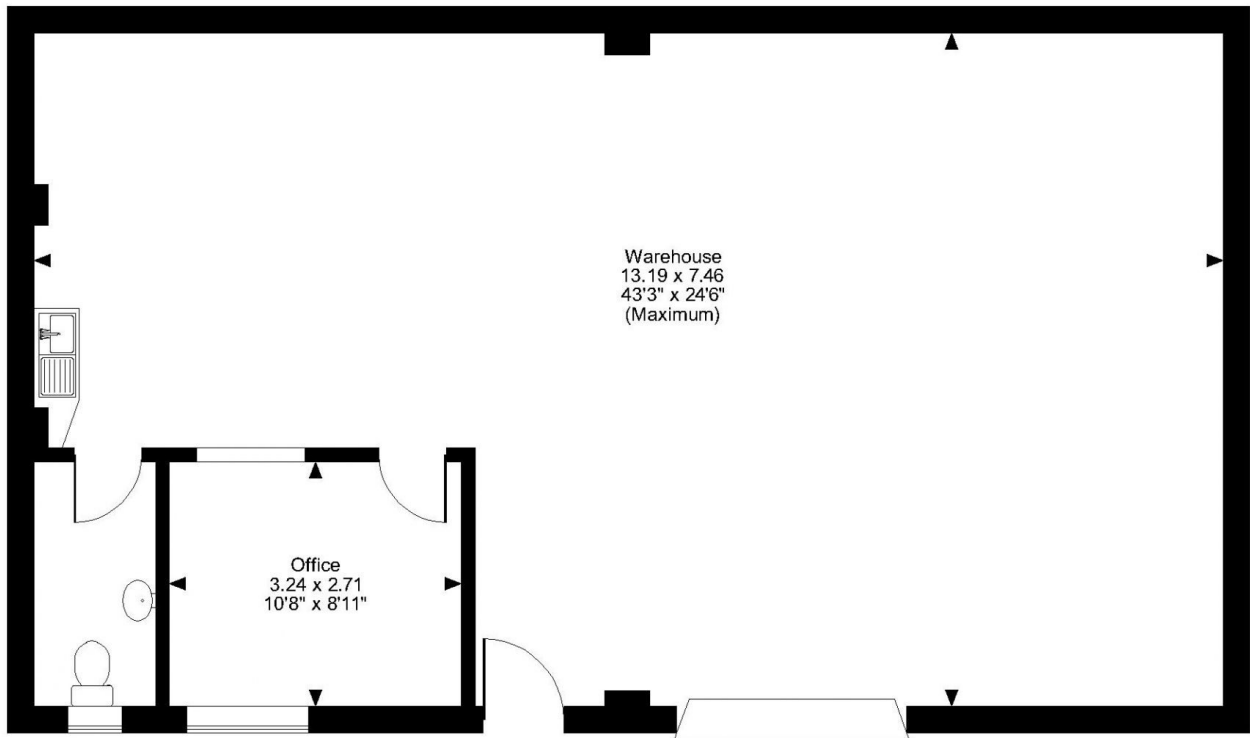
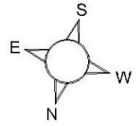

Ground Floor

FOR ILLUSTRATIVE PURPOSES ONLY - NOT TO SCALE

The position & size of doors, windows, appliances and other features are approximate only.

© ehouse. Unauthorised reproduction prohibited. Drawing ref. dig/8589215/PPM