

# Floor Plans

Unit 5 - 9973 sq ft | Chapel Brook Trade Park

📍 13 Wilson Road, Huyton, L36 6AW

Chapel Brook Trade Park, Wilson Road, Huyton  
Approximate Gross Internal Area  
6695 Sq Ft/622 Sq M

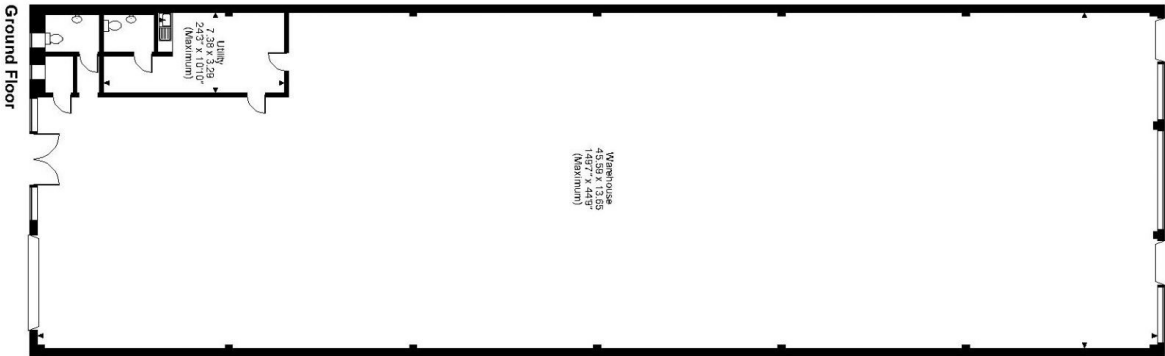
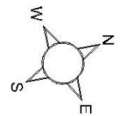

**FOR ILLUSTRATIVE PURPOSES ONLY - NOT TO SCALE**

The position & size of doors, windows, appliances and other features are approximate only.  
© ehouse. Unauthorised reproduction prohibited. Drawing ref. dig/85586855/SHU

[enquiries@industrials.co.uk](mailto:enquiries@industrials.co.uk)

➔ For more info please visit:  
[unit.info/UIP0101689](http://unit.info/UIP0101689)

+440 808 169 7554