



Different Wall Types - refer to drawing W038-S-DR-818

- W1 General Stud Wall - (with Insulation)
- W2 125mm composite wall panel
- W3 125mm composite wall panel (with stud lining)
- W4 Lift shaft precast conc' wall & liner
- W5 Wall Liner
- W6 Column Liner

Indicative Above Ground Drainage Positions:-
Internal Drainage 'pop-up' locations added as advised on MBA's Drawing: 20-246-M-760

- Drainage Stack
- Drainage Stack from Above
- Rodding Eye
- Floor Gully
- Drainage Pipework

UNIT 2 Warehouse

min. 12.0m to u/s haunch

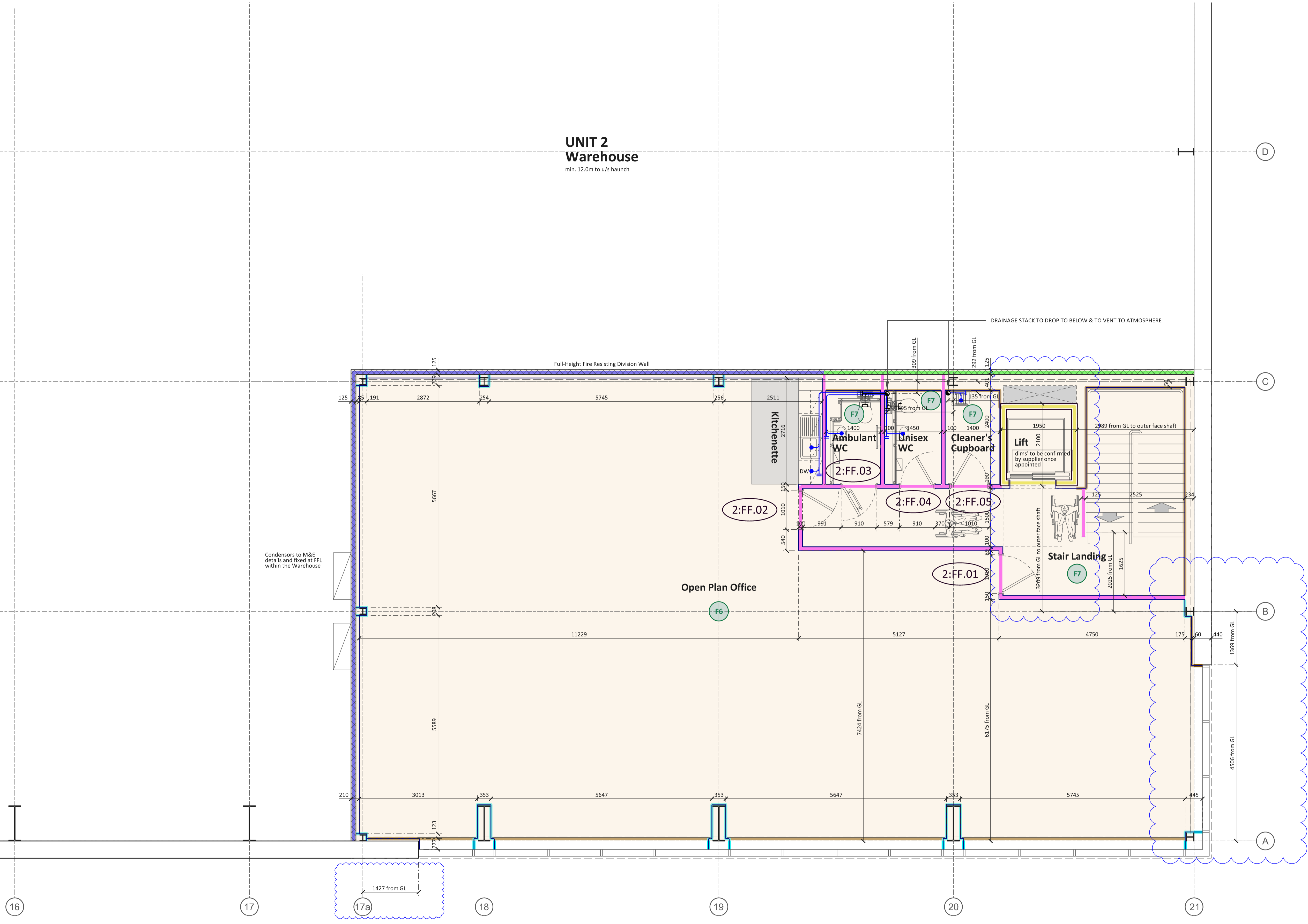

Condensators to M&E details and fixed at FFL within the Warehouse

Rev C5: Additional Dims added as requested. HM - 11.12.2022
 Rev C4: Lift Shaft adjusted. PAL - 02.12.2022
 Rev C3: Whitewall Thickness Changed. Internal Drainage 'pop-up' locations added as advised on MBA's Drawing: 20-246-M-760. Drainage stack positions slightly tweaked to a more suitable location / differs from MBA's positioning. Layout to be reviewed with EirEng. Additional Setting Out Dims' Added to Stair. HM - 29.11.2022
 Rev C2: Door Numbers adjusted to suit Door Schedule. HM - 20.09.2022
 Rev C1: Construction Issue. HM - 12.08.2022

Drawing Status:
CONSTRUCTION

CMP
Architects

Client



Project
Betty Road, Waltham Cross

Title
Unit 2
First Floor Level Core/ Office Plan

Scale
1:50@A1 / 1:100@A3
Drawn
HM
Date
01.08.2022

Dr. No.
W038-U2-DR-151
Revision
C5

Do not scale from this drawing, use figured dimensions only. Subject to accurate site survey. All dimensions to be checked and verified for any discrepancies. All drawings to be read in conjunction with all CMP Architects and other consultants' contract documentation. Any discrepancies to be reported before any work commences. All items installed by others are to be fully site coordinated and programmed with the Contractor. All products to be installed to manufacturers recommendations.
©Copyright CMP Architects Ltd

Unit 2 - First Floor Level Core/ Office Plan