

# north gatwick

GATEWAY



# UNIT 5

41,524 SQ FT LOGISTICS UNIT



Cross Oak Lane, Horley, RH6 8PP

 HILLWOOD  
A PEROT COMPANY®

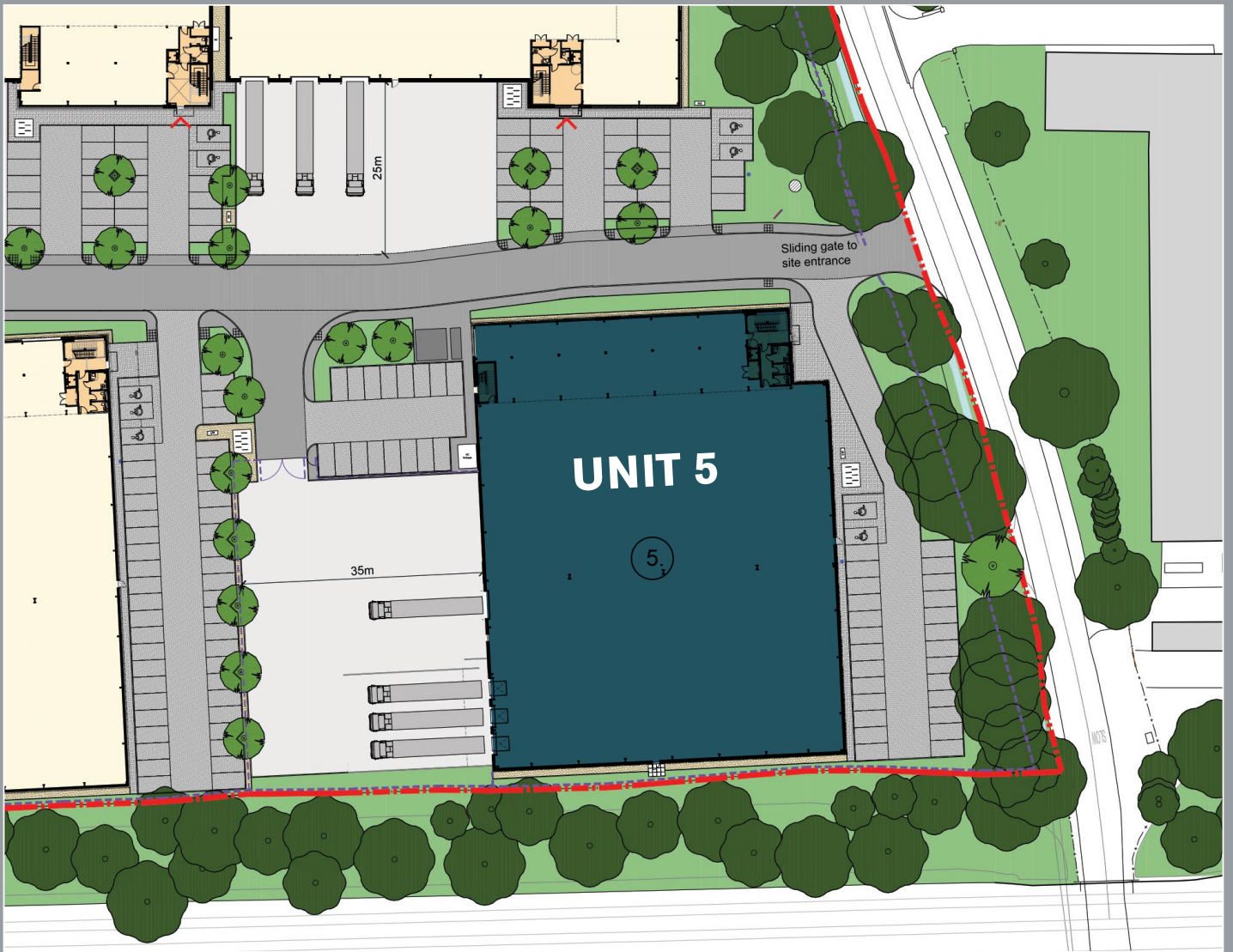

## Site Plan

### Unit 5

UNIT	GROUND GEA SQ.FT	FIRST GEA SQ.FT	TOTAL GEA SQ.FT
5	35,632	5,892	41,524

## SPECIFICATION

- 12.5m eaves
- EV charging
- 44 car parking spaces
- 3 dock level loading doors
- 1 ground level loading door
- Secure 35m deep yard
- Refurbished unit
- Gated estate
- EPC A
- LED lighting (offices)
- BREEAM 'Very Good'
- Air Source Heat Pumps



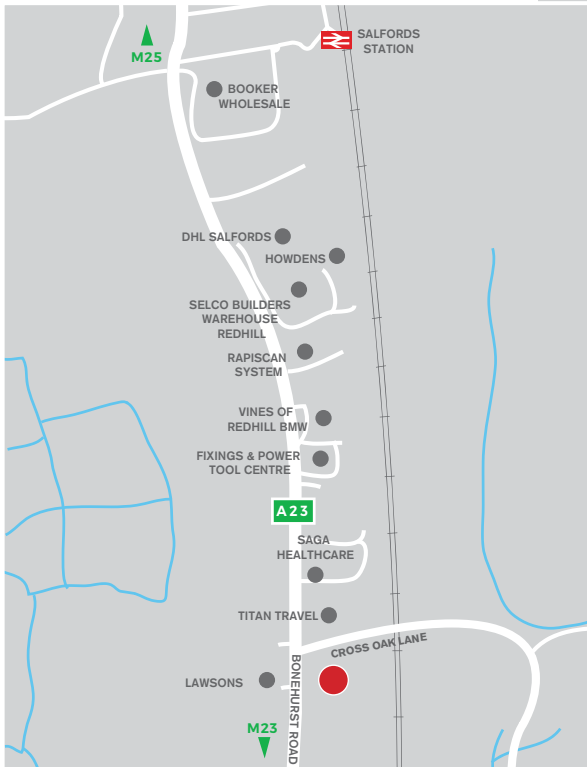

SAT NAV: RH6 8PP

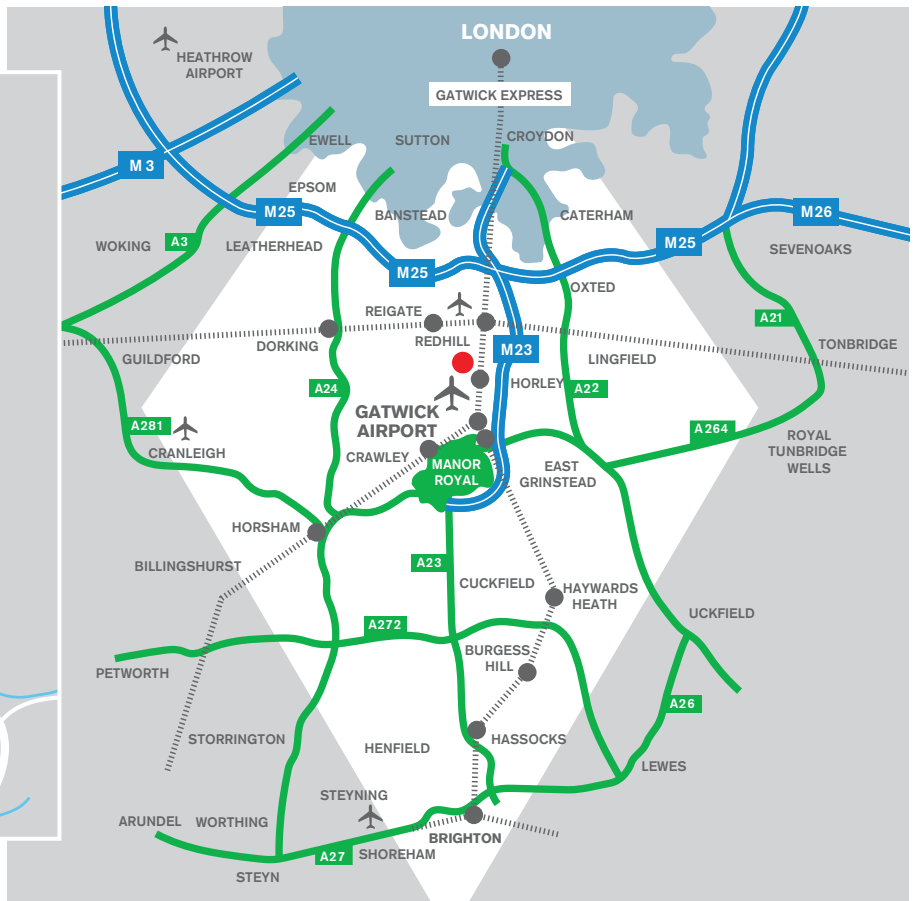

**ROAD**

M23 J8	4 MILES - 10 MINUTES
M25 J7	6 MILES - 15 MINUTES
GATWICK AIRPORT	2 MILES - 5 MINUTES
HEATHROW AIRPORT	35 MILES - 50 MINUTES
CENTRAL LONDON	30 MILES - 60 MINUTES
BRIGHTON	30 MILES 50 MINUTES
CRAWLEY	6 MILES - 15 MINUTES
SHOREHAM PORT	30 MILES - 50 MINUTES

**RAIL**

GATWICK EXPRESS	30 MINUTES
LONDON BRIDGE	29 MINUTES
LONDON ST PANCRAS	45 MINUTES
CLAPHAM JUNCTION	26 MINUTES
EAST CROYDON	14 MINUTES
BRIGHTON	22 MINUTES
CRAWLEY – VICTORIA	60 MINUTES

**Prime Location**

**UNIT 5, NORTH GATWICK GATEWAY**

Unit 5, NGG is located in the heart of the Gatwick Diamond just north of London Gatwick International Airport.

Located fronting the A23 Bonehurst Road, the A23 is the principle link road between Redhill to the North and Crawley to the South. Gatwick Airport is approximately 4 miles away. It has excellent transport links to the Southern M25 and A23/ M23. Access to the M23 (J9) and the national motorway network via the M25 (J7) provide great access to the South East.

Cross Oak Lane, Horley, RH6 8PP

**AGENT DETAILS**



**Alice Hampden-Smith** | 07508 371 884  
 alice.hampden-smith@dtre.com  
**Claudia Harley** | 07483 068 035  
 Claudia.harley@dtre.com  
**Jake Huntley** | 07765 154 211  
 Jake.huntley@dtre.com



**Tim Hardwicke** | 07989 420 989  
 thardwicke@shw.co.uk  
**Laura Miles** | 07947 373 275  
 lmiles@shw.co.uk



**Michael Deacon-Jackson** | 07939 136 295  
 mdj@ftdjohns.co.uk