

02 First Floor Units Indicative Layout

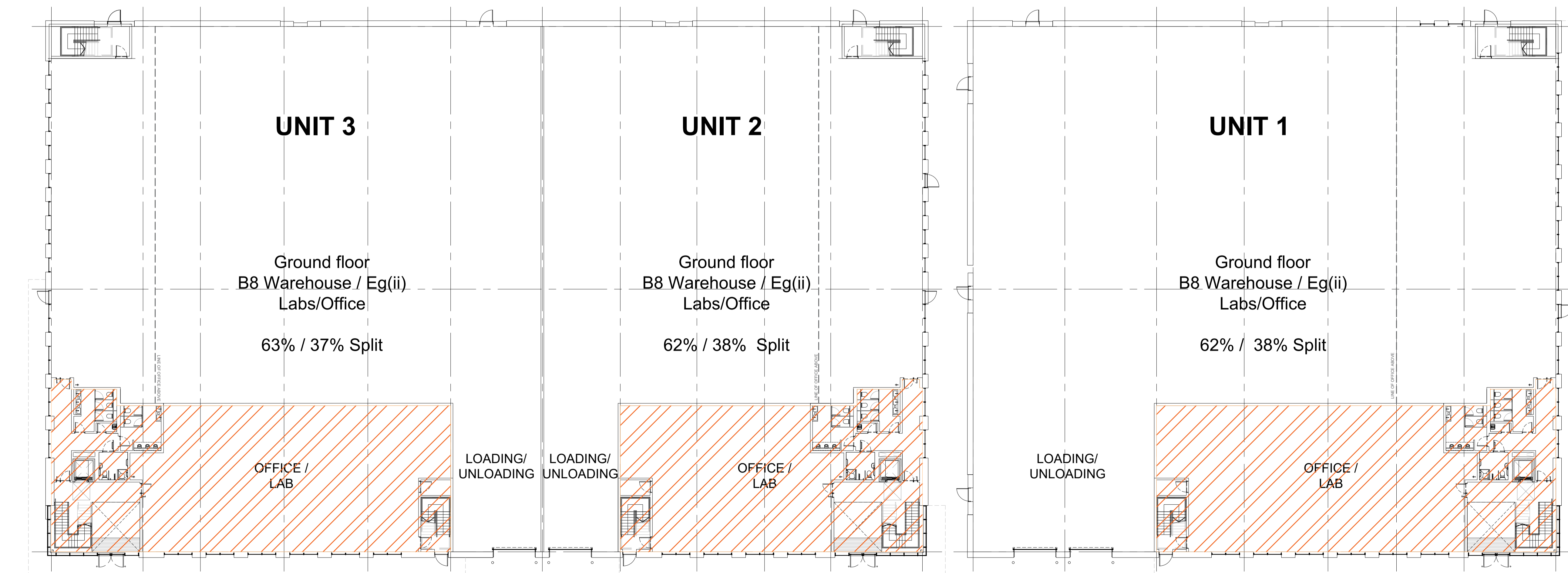

01 Ground Floor Units Indicative Layout

Disclaimer:
Subject to survey.

Notes:

- KEY**
- AREAS**
- Labs/Office Eg(ii)
 - Loading/Warehouse B8/Eg(ii)
 - Base Build Office/Lab Area

AREA SCHEDULE (GIA)

UNIT	Total Area
UNIT 1	29,623ft²
GF Warehouse/Eg(ii)	25,048ft ²
GF Office	4,768ft ²
FF Office (15%)	4,575ft ²
Car Parking Spaces	55
UNIT 1 incl. extension	34,563ft²
GF Warehouse/Eg(ii)	25,048ft ²
GF Office	4,768ft ²
FF Office incl extension(28%)	9,515ft ²
UNIT 2	19,687ft²
GF Warehouse/Eg(ii)	16,275ft ²
GF Office	3,714ft ²
FF Office (17%)	3,412ft ²
Car Parking Spaces	36
UNIT 2 incl. extension	22,906ft²
GF Warehouse/Eg(ii)	16,275ft ²
GF Office	3,714ft ²
FF Office incl extension(29%)	6,631ft ²
UNIT 3	25,618ft²
GF Warehouse/Eg(ii)	21,044ft ²
GF Office	4,876ft ²
FF Office (18%)	4,575ft ²
Car Parking Spaces	36
UNIT 3 incl. extension	28,837ft²
GF Warehouse/Eg(ii)	21,044ft ²
GF Office	4,876ft ²
FF Office incl extension(29%)	7,793ft ²

Total development	74,928ft²
Total development incl ext.	86,306ft²
Total car parking spaces	136
Total cycle parking	120
Total GF Footprint	62,367ft²
Previous PL approved GF Footprint	61,692ft²

G	Areas checked.	14.08.23	HT	HA
F	Use classes defined	09.08.23	HT	HA
E	Use classes defined	02.08.23	HT	HA
D	Cores for discussion	19.07.23	HT	HA
C	Update footprint	17.07.23	HT	HA
B	Update footprint	14.07.23	HT	HA
A	Update footprint	12.07.23	HT	HA
-	First Issue	12.07.23	SB	HA
Rev:	Notes:	Date:	Dwn:	Iss:

Suitability Code:



Client:

hale
ARCHITECTURE
22c Leathermarket Street, London, SE1 3HP

Project:
Dales Manor Business Park, Sawston

Drawing Title:
Full Mezzanine
GA Unit Plans
Ground and First Floor Plans

Project No: 22097	Scale @ A1: 1:200	Revision: G
----------------------	----------------------	----------------

Drawing No:
SK210