

TO LET – WORKSHOP / TRADE COUNTER UNIT



## Unit 4 - C1 Trade Park

Aberaman Park Industrial Estate

ABERDARE, CF44 6DA



## Trade Counter / Workshop Unit

284.20 sq m (3,059 sq ft)

### Property Highlights

- Terraced workshop / trade counter unit
- Fronting onto the B4275
- Level access loading door
- Minimum eaves height of 6.00m
- Office / welfare accommodation in situ
- Shared car parking to the front elevation

For further information, please contact:

**Rob Ladd**

+44 (0)29 2026 2254  
+44 (0)7912 798 717  
[rob.ladd@cushwake.com](mailto:rob.ladd@cushwake.com)

**Aric Asbridge**

+44 (0)117 910 5297  
+44 (0)7827 356012  
[aric.asbridge@cushwake.com](mailto:aric.asbridge@cushwake.com)

11-13 Penhill Road, Pontcanna, Cardiff,  
CF11 9PQ

[cushmanwakefield.com](http://cushmanwakefield.com)

# TO LET – WORKSHOP / TRADE COUNTER UNIT



## Unit 4 - C1 Trade Park

Aberaman Park Industrial Estate

ABERDARE, CF44 6DA

### Location

C1 Trade Park, which forms part Aberaman Park Industrial Estate, is located approximately one mile south of the town of Aberdare. Aberdare lies approximately 25 miles northwest of Cardiff and 8 miles west of Merthyr Tydfil.

The estate benefits from excellent road connections with direct access to the A4059 / A470. Both roads link to Junction 32 of the M4 motorway, 16 miles to the south.

The estate benefits from excellent road connections with direct access to the A4059 / A470. Both roads link to Junction 32 of the M4 motorway, 16 miles to the south. The Heads of the Valleys dual carriageway (A465) is approximately 5 miles to the north. Other occupiers on the estate include Screwfix, Toolstation and Royal Mail.

### Description

The unit in question comprises a mid terrace trade counter / workshop unit.

Vehicle loading is provided to the front elevation via a level access loading door with office and WC accommodation built in. Shared car parking is provided to the front elevation with a single entry / exit point into site via a shared accessway.

### Tenure

The property is available by the way of a new Full Repairing and Insuring lease, for a term of years to be agreed.

### Rent

£5.50 per sq ft

### Rateable Value

To be reassessed.

### Services

We understand that services are provided to the property, including mains water, drainage and three phase electricity. Interested parties are advised to make their own enquiries to establish their suitability, connectivity and capacity.

### Energy Performance Certificate

C (72)

A full copy of the EPC will be made available to enquiring parties.

### VAT

VAT will be charged on all costs.

### Legal Costs

Each party is to bear their own legal and surveyors costs incurred in the transaction.

### Anti-Money Laundering Regulations

In order to discharge its legal obligations, including under applicable anti-money laundering regulations, C&W will require certain information of the successful bidder. In submitting a bid, you agree to provide such information when Heads of Terms are agreed.

### Viewing

For further information and to arrange an inspection, please contact:

#### Rob Ladd

+44 (0)29 2026 2254

+44 (0)7912 798 717

rob.ladd@cushwake.com

#### Aric Asbridge

+44 (0)117 910 5297

+44 (0)7827 356012

aric.asbridge@cushwake.com

April 2024

# TO LET – WORKSHOP / TRADE COUNTER UNIT



## Unit 4 - C1 Trade Park Aberaman Park Industrial Estate ABERDARE, CF44 6DA

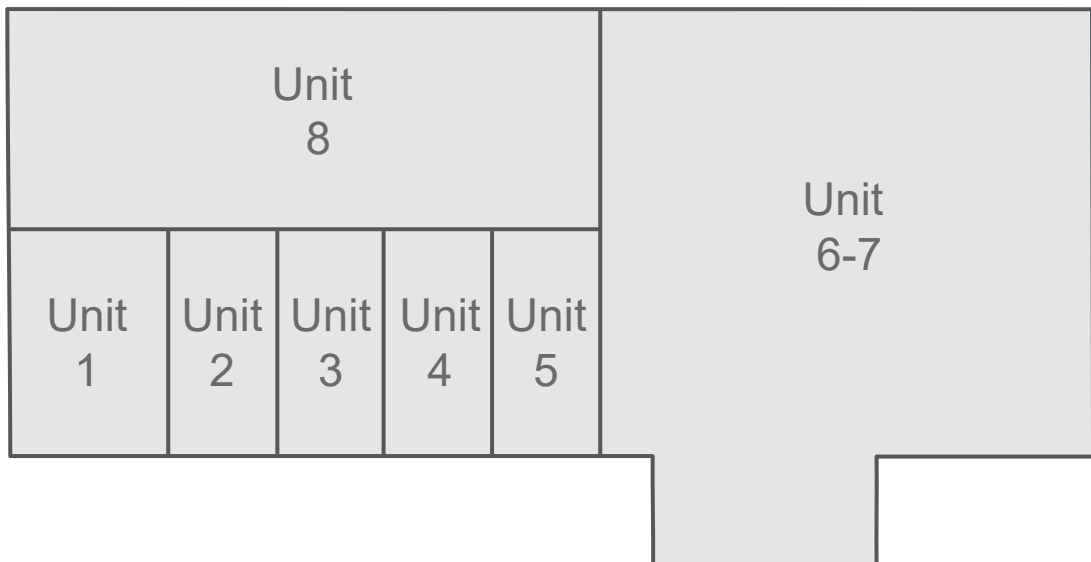
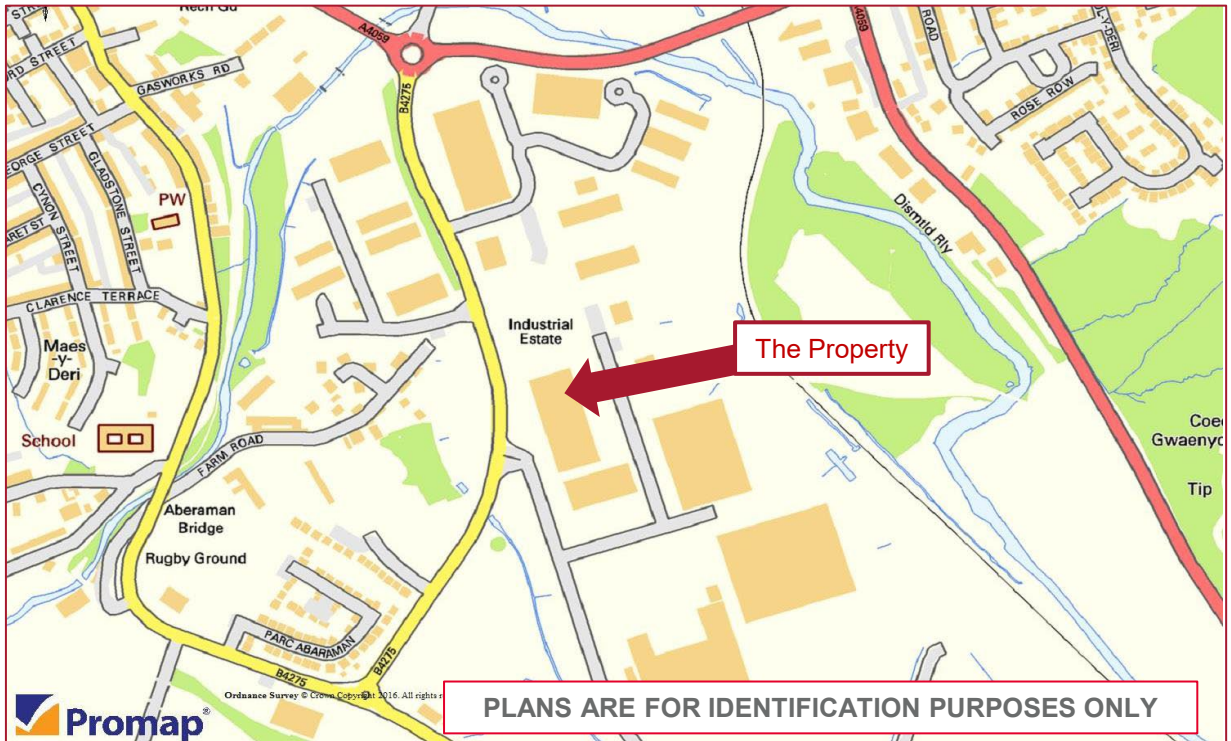

For identification purposes only

Cushman & Wakefield gives notice to anyone who may read these particulars as follows: 1. These particulars are prepared for the guidance only of prospective purchasers. They are intended to give a fair overall description of the property but are not intended to constitute part of an offer or contract. 2. Any information contained herein (whether in the text, plans or photographs) is given in good faith but should not be relied upon as being a statement or representation of fact. 3. Nothing in these particulars shall be deemed to be a statement that the property is in good condition or otherwise nor that any services or facilities are in good working order. 4. The photographs appearing in this brochure show only certain parts and aspects of the property at the time when the photographs were taken. Certain aspects may have changed since the photographs were taken and it should not be assumed that the property remains precisely as displayed in the photographs. Furthermore no assumptions should be made in respect of parts of the property which are not shown in the photographs. 5. Any areas measurements or distances referred to herein are approximate only. 6. Where there is reference in these particulars to the fact that alterations have been carried out or that a particular use is made of any part of the property this is not intended to be a statement that any necessary planning, building regulations or other consents have been obtained and these matters must be verified by any intending purchaser. 7. Descriptions of a property are inevitably subjective and the descriptions contained herein are used in good faith as an opinion and not by way of statement of fact.