

BUILDING
FOUR
MORETOWN, E1

11,890 Sq Ft Fourth Floor Offices Available to Let

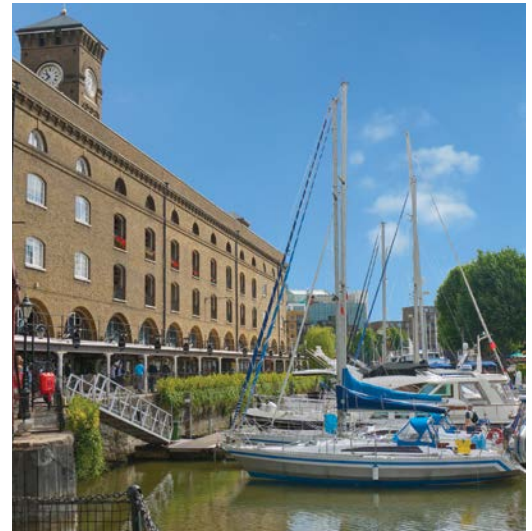



Indicative fit-out



4th floor offices



Indicative fit-out

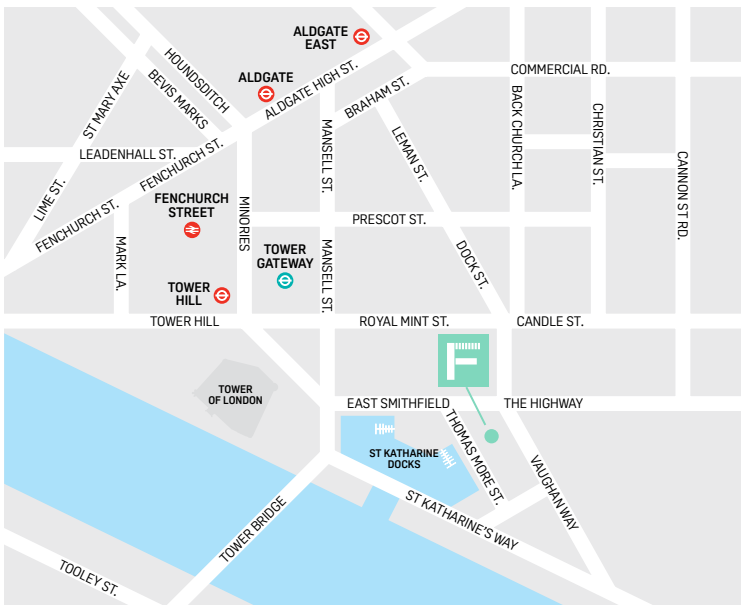

DESCRIPTION

Building 4 is arranged over lower ground, ground and eight upper floors, extending to 107,802 sq ft in total. The fourth floor benefits from a centralised atrium, which allows for plenty of natural light. It is offered with the existing fit out, including a number of meeting rooms and private offices.

SPECIFICATION

- Recently refurbished reception
- Metal tiled suspended ceiling
- Fully accessible raised floors
- VAV air conditioning
- 4 x passenger lifts
- 24 hour access and security
- Car parking
- Splits available from 5,000 sq ft

4TH FLOOR PLAN – 11,890 SQ FT (1,104 SQ M)

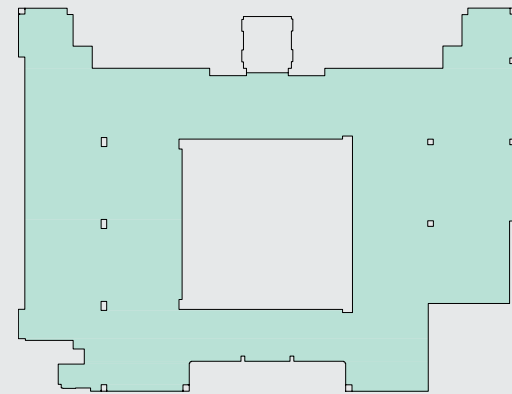

Plan not to scale, for indicative purposes only.

LOCATION

The newly rebranded Moretown Estate (previously known as Thomas More Square) is located on the Eastern side of the City adjacent to the haven of St. Katharine Docks.

The property is within easy walking distance from Tower Hill underground, Tower Gateway DLR, London Bridge and Fenchurch Street stations providing access to the City, Canary Wharf, Southwark and West End.

The Estate has benefitted from an upgrade to the piazzas, courtyards and landscaping along with a range of new retail and leisure amenities.

TERMS

Upon application.

VIEWINGS

Strictly through sole letting agents:

Alex Novelli
020 3296 2133
alex.novelli@cushwake.com

Tom Fayers
020 3296 4226
tom.fayers@cushwake.com

