

Dimensions to be verified on site. Figured dimensions to be taken in preference to those scaled.
 This drawing is the property of Adex Interiors For Industry Limited. Copyright is reserved by them and issued on the condition that it is not copied, reproduced, related or disclosed to any unauthorised party or in part without the consent in writing of Adex Interiors For Industry Limited.

LEGEND.

- ⊠ T1 - EXISTING FLOOR BOX.
2 x DOUBLE SOCKET OUTLETS.
4 x DATA.
- ⊠ T2 - EXISTING FLOOR BOX.
2 x DOUBLE SOCKET OUTLETS.
2 x DATA.
- ⊠ T2 - NEW FLOOR BOX.
2 x DOUBLE SOCKET OUTLETS.
2 x DATA.
- ⊠ T3 - NEW FLOOR BOX.
1 x DOUBLE SOCKET OUTLETS.
- CLEANER SOCKETS.

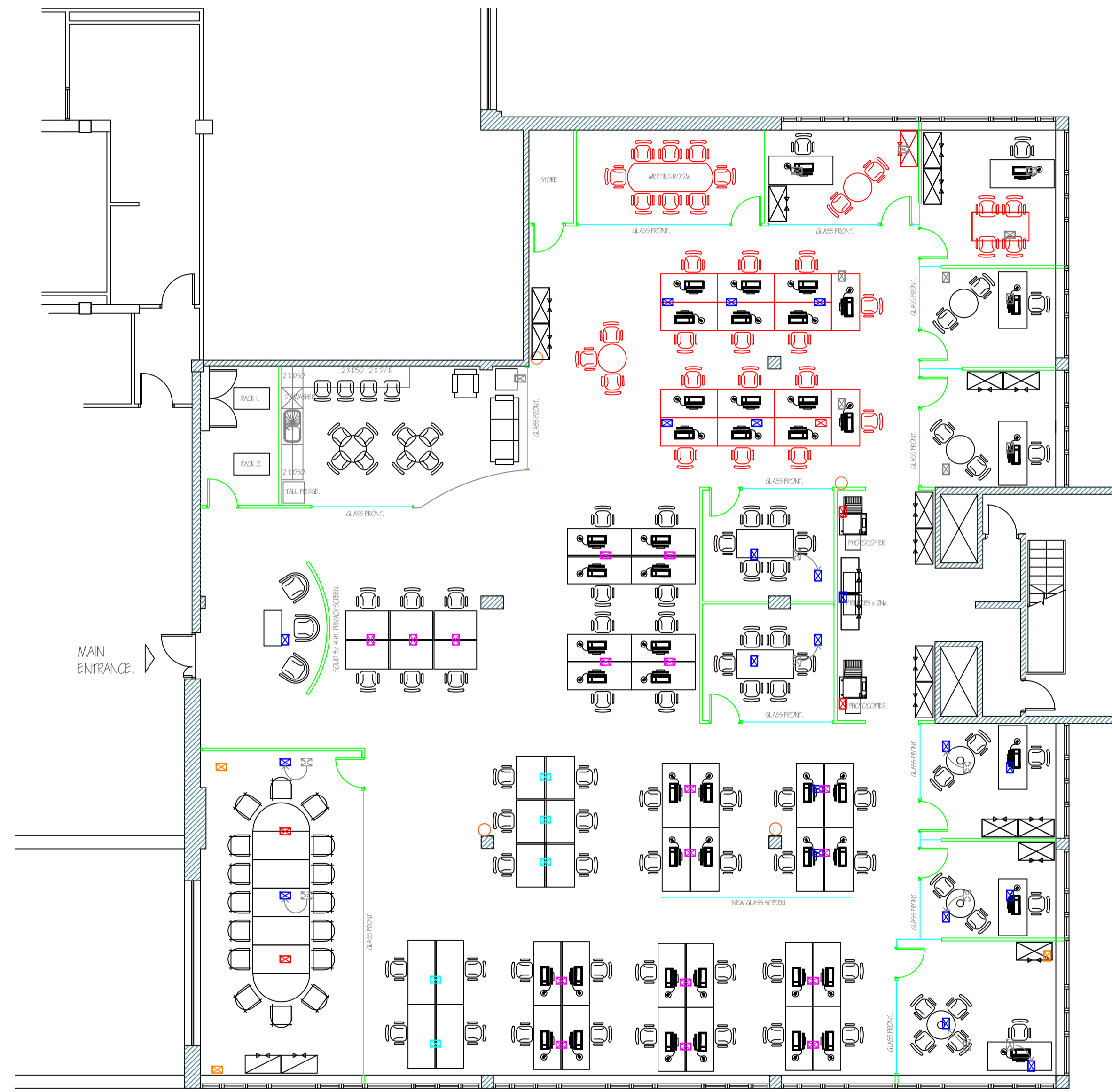

PROPOSED FIRST FLOOR LAYOUT PLAN.

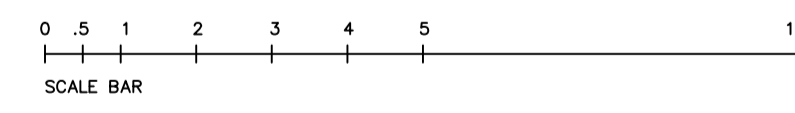

Adex Interiors
 5 Avebury Court
 Mark Road
 Hemel Hempstead
 Hertfordshire
 HP2 7TA



Tel 01442 232327
 Fax 01442 262713
 Email info@adex.co.uk
 Web www.adex.co.uk
 An HSI Group Company www.hsigroup.co.uk

Client

 Smiths

Project

 First Floor
 Croxley Building 7.

Desc.

 Proposed Floor Box
 Layout Plan.

Drawing No. 3025 - 01	Rev. No.
Scale 1:100	Date Aug 2017
Drawing By	Approved By