



Falkirk Council

## Heathrigg Nursery Asbestos Management Plan

Review Date:  
March 2014

Asbestos insulation board has been identified within the switch room. All maintenance and refurbishment activities requiring work on this material **must be carried out by a licensed asbestos removal contractor.**

Vinyl flooring and textured coated ceilings have also been identified with an asbestos content in some areas of the building. Areas of Asbestos found are shown on the attached plans with references to the Asbestos Management Survey to provide more detailed information on the location of the asbestos materials. **Removal of these asbestos materials can be carried out by a competent contractor as non licensed work.**

A targeted Refurbishment Survey will be required prior to any work being carried out if not specifically shown on the Plans. Development Services Construction Support must be notified of any work on asbestos containing material or for advice on whether removal will be required – **Tel 01324 504905 or email - [asbestosdevserv@falkirk.gov.uk](mailto:asbestosdevserv@falkirk.gov.uk)**)

**All works to be carried out in *Heathrigg Nursery* will be subject to a Permit to Work System.**

### PERMIT TO WORK

A permit to work in is required for all works carried out on the fabric of the building including survey work. The permit will confirm that contractor's employees have been notified of the presence of asbestos and are aware of the restrictions imposed.

**All tradesmen (including Council employees) will be required to sign in at reception and complete the permit to work.**

Works involving planned work to areas identified as containing Asbestos will require the contractors to submit a completed permit to work form for approval, with all relevant documentation, to Development Services, Roads & Design, Construction Support at least 48 hrs prior to the planned start date.

Contractors working out of hours on emergency work will be required to notify the Nursery Management & Development Services Construction Support as soon as possible after accessing the building with details of the works carried out.

A copy of all permits issued will be recorded and retained by the school management.

### Documents attached:

Appendix 1. Risk assessment.

Appendix 2. Permit to work Pro-forma.

Appendix 3. Location plans for asbestos material -

## Appendix 1

## Priority Risk Assessment of Known Asbestos Materials

(See table 1 Algorithm attached (average per section))

Sample No	Room No	Occupant Activity (MAX 6)	Likelihood of disturbance (MAX 9)	Human exposure potential (MAX 9)	Maintenance activity (MAX 6)	Material risk assessment (MAX 12)	Total Score (MAX 24)	Action Required
006 Residue to joists	012	0	1	1	0	11	13 Med	Monitor. Work on this material will require a plan of work to be submitted to Development Services, Construction support for approval. <b><i>Care to be taken to avoid damage to this material – All work to be carried out by a licensed asbestos removal contractor.</i></b>
005 insulating board		0	1	1	0	5	7 Low	
004 Vinyl tiles	012 & 015	0	1	1	0	3	5 low	Monitor and remove if work requires it.
001, 003, 007, 009, 011, 013, 015, 016. textured coatings	005, 011, 013, 014, 016, 017, 019, 020, 021, 022, 024, 025, 027, 029.	1	2	2	1	2	8 Low	Monitor and remove if work requires it.

## Appendix 2



Falkirk Council

# Heathrigg Nursery, Slamannan

Permit No  
Date

## PERMIT TO WORK

**HAZARD:** Asbestos materials are located as shown on attached plans and asbestos survey.

<b>Contractor Name,</b>			
<b>Address</b>			
<b>Telephone Number</b>		<b>Email address</b>	

**Description of work: attach copies of the work order or project drawings.**

Is work required on the asbestos materials identified in the areas shown in RED on the attached location plans? YES / NO

(If YES refuse access unless the documents below have been checked and approved by the person authorising the works)

Documents Required	Documents Supplied	Checked By
Method statements	Yes ( ) No ( )	
Risk Assessments	Yes ( ) No ( )	
Medical Certificates	Yes ( ) No ( )	
Training Records	Yes ( ) No ( )	
Asbestos Contractor Check List (to be completed by Construction Support)	Yes ( ) No ( )	
	IF NO REFUSE PERMIT	

I have read and understood this permit and will undertake work in accordance with the conditions in it.	<b>Signature:</b>	<b>Date:</b>

**Permit issued by:**

**Signature:**

**Date**

**Work Completed:**

**Signature:**

**Date**

**HAZARDS IDENTIFIED:**

Textured coating. to ceilings beams and columns have been identified as asbestos insulation

**Provide List of Employees, including signature, showing that they have been notified of the above HAZARD [see over]**

**LIST OF EMPLOYEES**

NAME	SIGNATURE	DATE

SAMPLE







## ASBESTOS CONTRACTOR CHECK LIST

Address:					
Date:			Time:		
Contractor:					
H.S.E Licence Asbestos Work	YES	NO	Licence No.:		
H.S.E. Notification	YES	NO	Number:		
Risk Assessment/Method Statement:	YES	NO	Suitable/Sufficient	YES	NO
Plant Testing:	Plant Type:		Serial Numbers:		
DCU	Clearance Certificate		YES	NO	
	Negative Pressure Unit (DOP test certificate)		YES	NO	
Training Records	Name:		YES	NO	
Face Fit Test Results	Name:		YES	NO	
Medical Records	Name:		YES	NO	
Falkirk Council Order	YES	NO	Number:		
Contractor's Order	YES	NO	Number:		
Comments:					

## Appendix 3



KEY

-  ASBESTOS LOCATION
-  SAMPLE LOCATION
-  ASBESTOS REMOVED
-  AREAS OF NO ACCESS
-  STAIRS
-  DUCT/VOID ACCESS
-  SPECIFIED AREAS

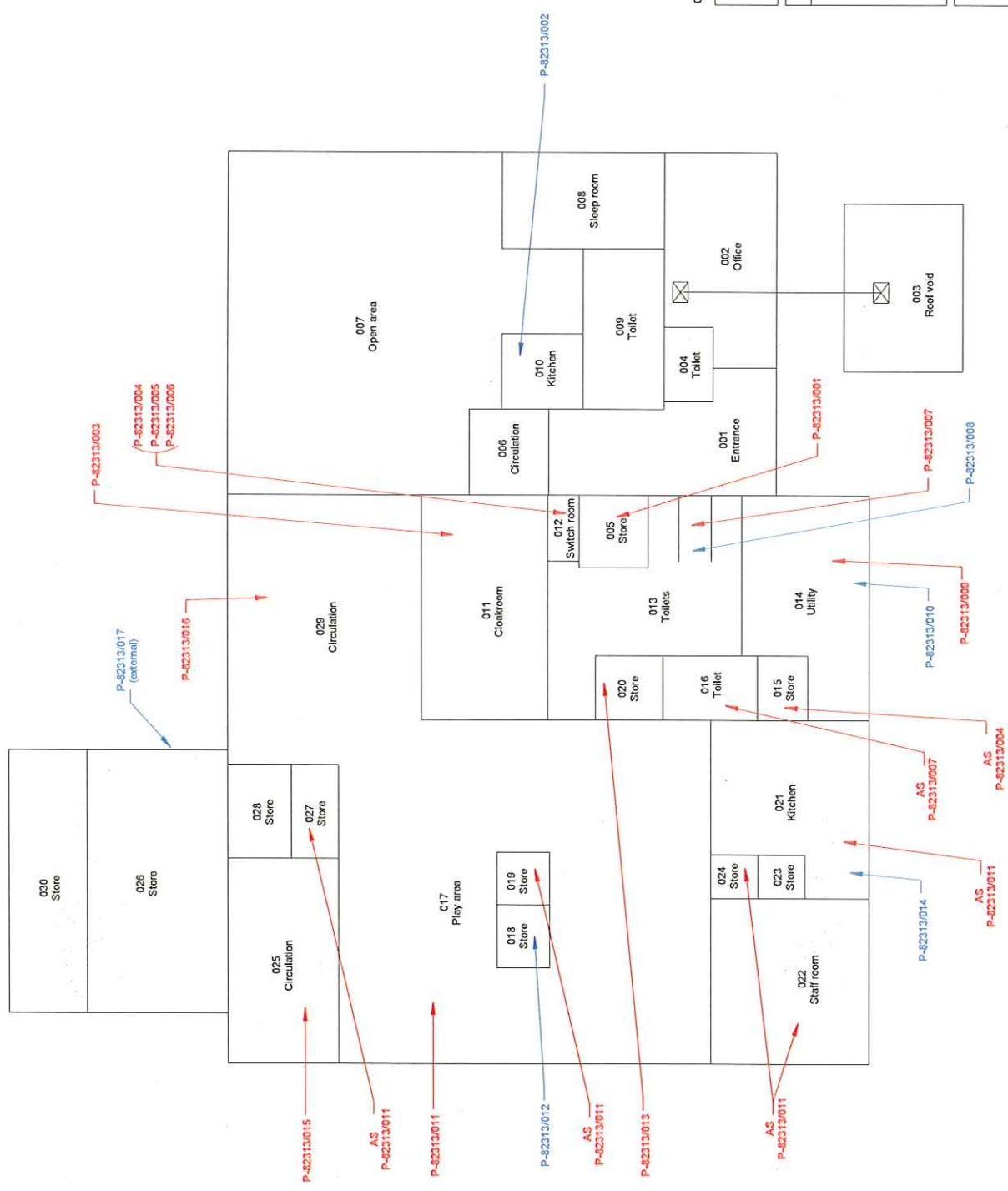

031 - External

DRAWING: Ground Floor

SHEET: 1 of 1

[NOT TO SCALE]

SITE NAME: HEATHRIGG NURSERY

SITE ADDRESS:  
Bank Street  
Slamannan

PROJECT:  
P-82313  
SURVEY DATE:  
13/02/13

SURVEYOR:  
IM / AC  
DRAWN BY:  
AD

CLIENT:  
FALKIRK COUNCIL DEVELOPMENT SERVICES

environmental essentials

Scotland Office  
Suite 18 Evans Business Centre,  
Bellshill Industrial Estate,  
Belgrave Street,  
Bellshill,  
ML4 3NP  
Telephone 01698 574557  
Facsimile 01698 574558