

Lock Up Retail Unit To Let

Kingsley Avenue | Kettering | Northamptonshire | NN16 9EX



- Retail unit with storage / staff room
- Net internal area approx. 550ft² (51m²)
- Within a popular residential area
- Available on a new lease
- Front roller shutter door
- Asking rent £15,000

BERRYS
berrys.uk.com

Location

The property is located in a predominantly residential area to the Northern part of Kettering and near to Rockingham Road which is close to J7 of the A14 and the A6003 to Corby.

Description

The property is a single storey red brick building with a pitched slate roof that was split into two separate retail units some years ago. The retail unit was recently used as a salon and comprises an open planned area with tiled flooring which flows through to a further storage area also tiled. WC facility included and roller shutter door to the fully glazed floor to ceiling shop front. There is roadside parking out the front.

Accommodation

The property is approx. 550 ft² (51m²) based on a net internal area and excluding the WC facility.

Terms

The property is available on a new lease at terms to be agreed with an asking rent of £15,000 per annum exclusive of all other outgoings.

Business Rates

The property has a rateable value of £5,300 and may be eligible for 100% rates relief subject to meeting the correct criteria.

Interested parties should check via the local authority for amounts payable.

Planning

The property has been a retail unit for many years and is suitable for E Class users.

Services

The property benefits from mains electricity and mains water. There is no gas connected to the property.

Legal Costs

Each party to bear their own. An undertaking for reasonable abortive legal costs may be required from the applicant.



VAT

VAT is not applicable to the rent.

EPC

A copy of the EPC is available on request.

Viewing Contact

Viewing strictly by appointment with the sole agent. Contact Kevin O'Dell on 01536 517777 kevin.odell@berrys.uk.com

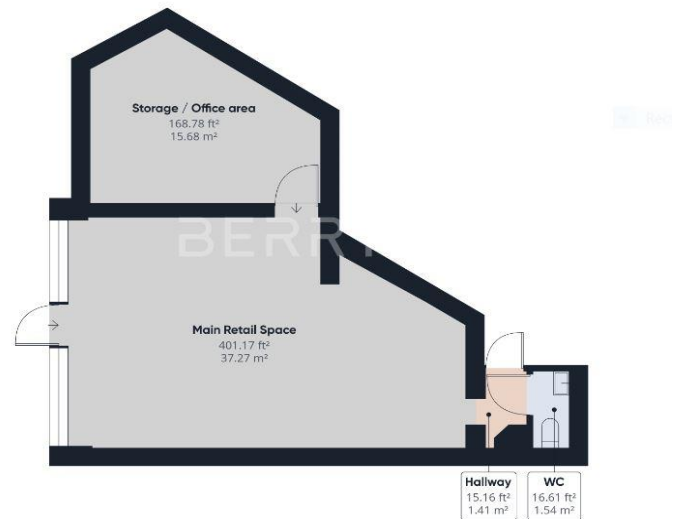

To book a viewing, please contact:

Kevin O'Dell

T: 01536 213176 | E: kevin.odell@berrys.uk.com

42 Headlands, Kettering, Northamptonshire, NN15 7HR

Important Notice

Berrys, their clients, and any joint agents give notice that:

1. These particulars are prepared for the guidance only of prospective purchasers and are intended to give a fair overall description of the property but do not form part of any offer or contract.
2. Any information contained herein (whether in the text, plans or photographs) is given in good faith but should not be relied upon as being a statement or representation of fact.
3. Nothing in these particulars shall be deemed to be a statement that the property is in good condition or otherwise, that any service or facilities are in good working order, or that the necessary statutory requirements have been met.
4. The photographs appearing in these particulars show only a certain part and aspect of the property at the time when the photographs were taken. Certain aspects may have changed since the photographs were taken and it should not be assumed that the property remains precisely as displayed in the photographs. Furthermore, no assumptions should be made in respect of parts of the property which are not shown in the photographs.
5. Any areas measurements or distances are approximate.
6. They are not authorised to make or give any representation or warranty whatsoever in relation to the property.
7. Purchasers must satisfy themselves by inspection or otherwise.

Ref: KA47422