

3rd Floor.

Extend landing using precast concrete unit to line through with the existing top riser, allow for alterations to existing handrail. Ramp to colour contrast with Landing and raised access floor finishes.

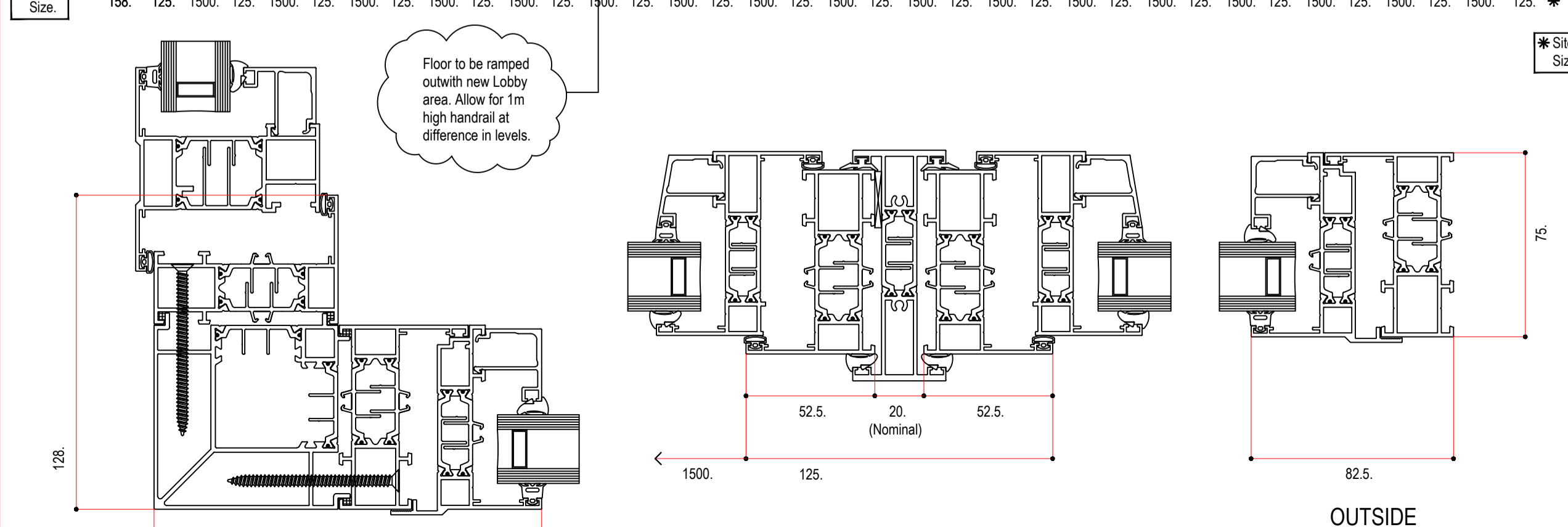
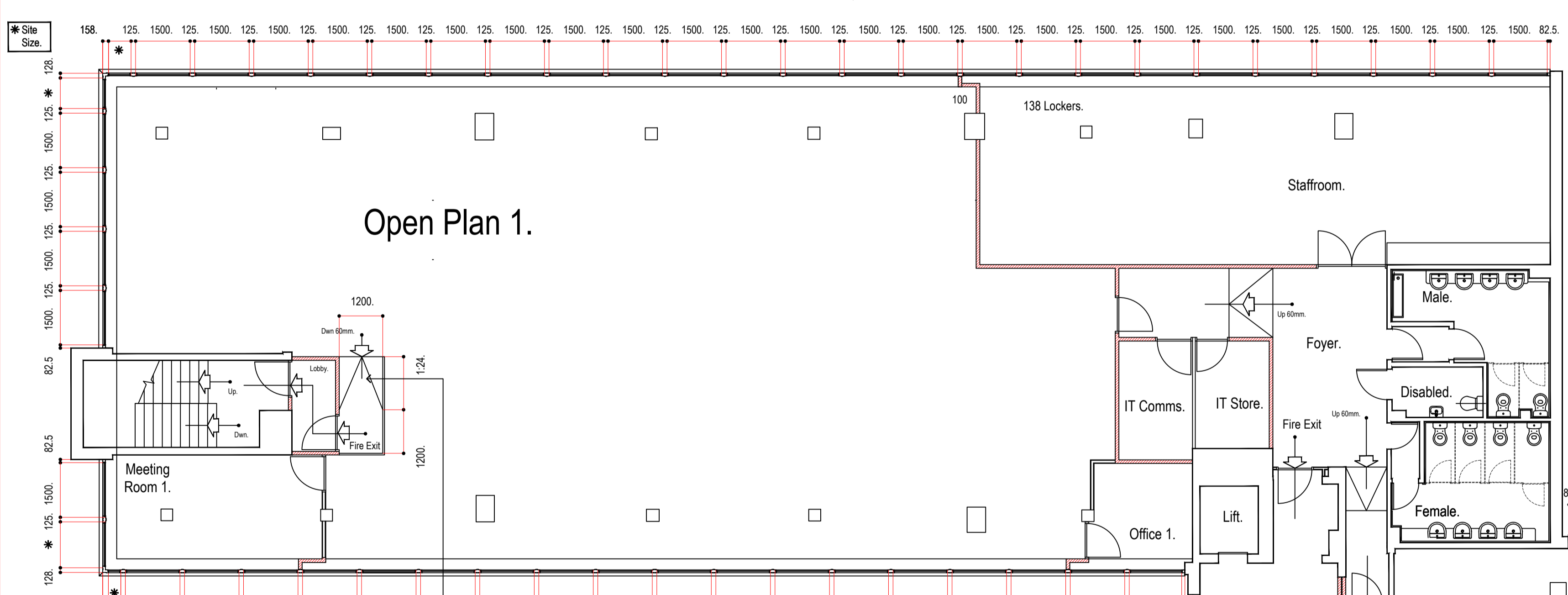
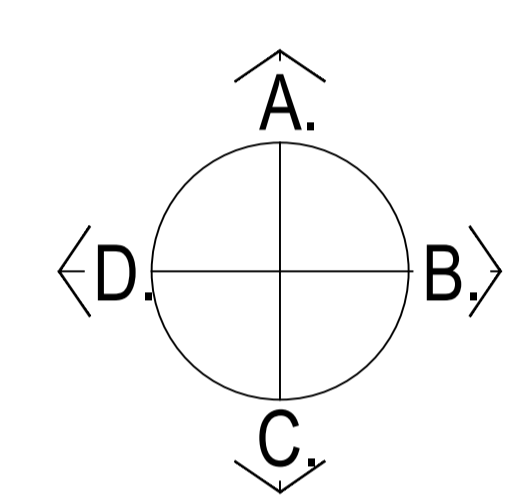

Natural Ventilation:
 Rooms to be by the provision of a ventilator with an opening area of at least 1/30th of the floor area of the room it serves, and
 - a trickle ventilator with an opening area of at least 4000 mm², if the area of the room is not more than 10 m²; or
 - a trickle ventilator with an opening area of 400 mm² for each square metre of room area, if the area of the room is more than 10 m²; or
 The trickle ventilator should be so positioned that a part of it is at least 1.75 m above floor level.
 A trickle ventilator should be provided in an area containing mechanical extraction to provide replacement air and ensure efficient operation when doors are closed. The trickle ventilator should be independent of the mechanical extract so that replacement air can be provided when the extract fan is operating. The location of the trickle ventilator and the extract fan should be located to prevent short-circuiting of the air.

Aluminium Windows, Top Hung and Fixed Glazing:
 Certification: Provide independently certified evidence that all incorporated components comply with the specified performance requirements.
Site Dimensions: Before starting work on designated items the Contractor shall take site dimensions and record on shop drawings.
Manufacturer to be Metal Technology Ltd, Product Reference System 4-35 High Insulation Casement Windows.
 Material extruded profile from aluminium alloy 6060 T6, T5 or T4 complying with BS EN 12020-2:2008/BS 755-9: 2008.
 Finish to be polyester powder coated to BS EN 12206, colour white with a minimum 40 micron film thickness.
 Fabricators are to ensure that all profiles, panels, flashings are in accordance with the corrosion classifications laid down in ISO 12944-2.
 Glazing system to be 28mm thick double glazed, hermetically sealed units to BS EN 1279 Parts 2 and 3.
 Glazing: inner pane 6mm toughened, low E, clear.
 Cavity: 16mm, 90% Argon gas filled.
 Outer pane 6mm toughened, SGG Cool-ite SKN 174 Neutral solar control coating.
 Fabricators must verify suitability of glass performance for each location and all glass and glazing shall conform to BS 6262: Parts 1-6: 2005. Glazing in Buildings and BS 6206: 1994, Specification for Impact Performance Requirements.
 Thermal Performance, average weighted maximum U Value 1.6W/m²K.
 Accessories, powder coated aluminium flashings, cills, perimeter trims as clearly identified.

Incorporated components, trickle ventilators, Glazing Fabricator to seek approval regarding vent type and whether rod or controls are also required, internal and external canopies to be provided colour white.
 Other requirements, to be designed, fabricated and installed in accordance with Metal Technology's Instructions, by authorised Fabricators, aluminium glazing system company must be SBD Member Company.
 Windows shall be restricted with a sprung releasable device to prevent the passage of a 100mm sphere through the opening in accordance with BS 8213 and Building Regulations. Restrictors shall automatically re-arrange on closing, ironmongery / Accessories; Stainless steel friction hinges, euro-espagnolette multi point lock with keeps and locking handle. Handles to be located for easy operation.

Fixings: Installed within the existing prepared structural openings with proprietary fixing lugs and coupling mullions as continuous ribbon windows.
Execution: Do not deliver to site components that cannot be installed immediately or placed in clean, dry floored and covered storage, store components by stacking vertically or near vertical on level barriers, separated with spacers to prevent damage by and to projecting ironmongery, beads, etc
Building In: Not permitted, brace and protect components to prevent distortion and damage during construction, of adjacent structure.
Window Installation Generally: Install into prepared openings with a gap between the frame edge and construction, minimum by Manufacturer, maximum 10mm allow for installing windows without twist or diagonal racking.
 Existing damp proof courses ensure that the windows are installed to adequately lap the existing damp proof courses.
Fixing of Aluminium Frames: Fasteners as proposed by the Fabricator and Installer, spacing when not predrilled or specified otherwise, position fastener not more than 250mm from the ends of each jamb, adjacent to each hanging point of opening lights, and at 600mm maximum centres.
Sealant Joints: Contractor to submit proposals including Product reference for the C.A's approval, application to prepared joints, finished triangular fillets to a flat or slight convex profile.
 Ironmongery, Assemble and fix carefully and accurately using fasteners with matching finish supplied by the ironmongery manufacturer, do not damage ironmongery and adjacent surfaces. Check, adjust and lubricate on completion and ensure correct functioning.
 Cleaning of Windows: Will be carried out by a Specialist Contractor externally from the existing ground level.

Each opening sash provides a clear vent open area of 1.07sq.m.

| Room | Minimum number of opening sashes. | Minimum trickle vent area. |
|---|-----------------------------------|----------------------------|
| HR Manager. Room Area : 14.5sq.m. | 1 number. | 5800sqmm. |
| Human Resources. Room Area : 29sq.m. | 1 number. | 11600sqmm. |
| Finance Controller. Room Area : 13.04sq.m. | 1 number. | 5216sqmm. |
| Finance Controller. Room Area : 47.7sq.m. | 2 number. | 19080sqmm. |
| Customer Care Etc. Room Area : 160sq.m. | 5 number. | 64000sqmm. |
| Meeting Room 1. Room Area : 23.2sq.m. | 1 number. | 9280sqmm. |
| IT Manager. Room Area : 15.8sq.m. | 1 number. | 6320sqmm. |
| IT. Room Area : 50.4sq.m. | 2 number. | 20160sqmm. |
| Admin. and Facilities. Room Area : 44.3sq.m. | 2 number. | 17720sqmm. |
| Compliance Manager. Room Area : 12.9sq.m. | 1 number. | 5160sqmm. |
| Legal Manager. Room Area : 17sq.m. | 1 number. | 6800sqmm. |
| Open Plan 1. Room Area : 317.4sq.m. | 10 number. | 126960sqmm. |
| Meeting Room 1. Room Area : 18.8sq.m. | 1 number. | 7520sqmm. |
| Staffroom. Room Area : 81.3sq.m. | 3 number. | 32520sqmm. |
| Office 1. Room Area : 7.8sq.m. | 1 number. | 4000sqmm. |
| Open Plan 2. Room Area : 245.8sq.m. | 8 number. | 983200sqmm. |
| Office 2. Room Area : 7.7sq.m. | 1 number. | 4000sqmm. |

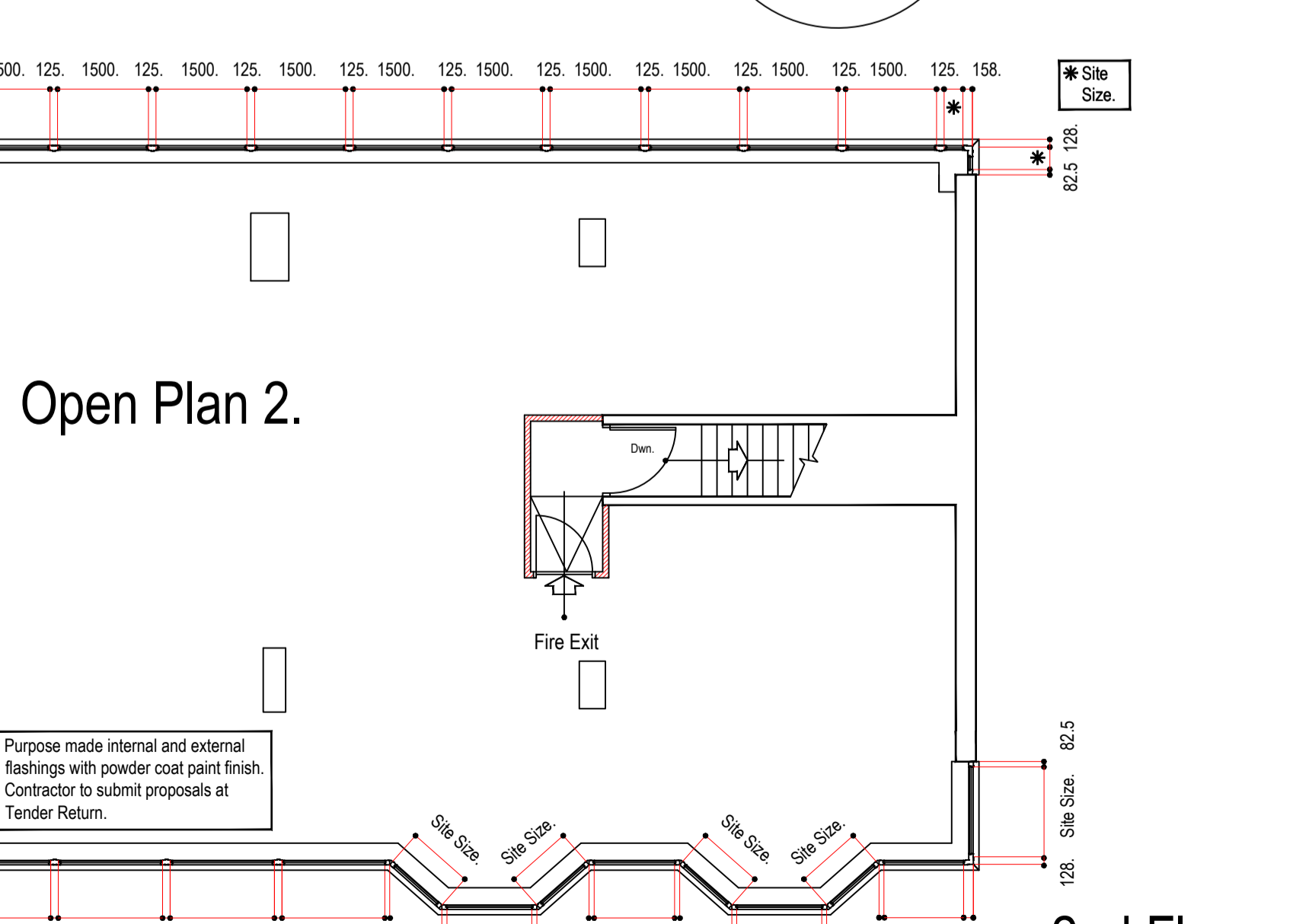
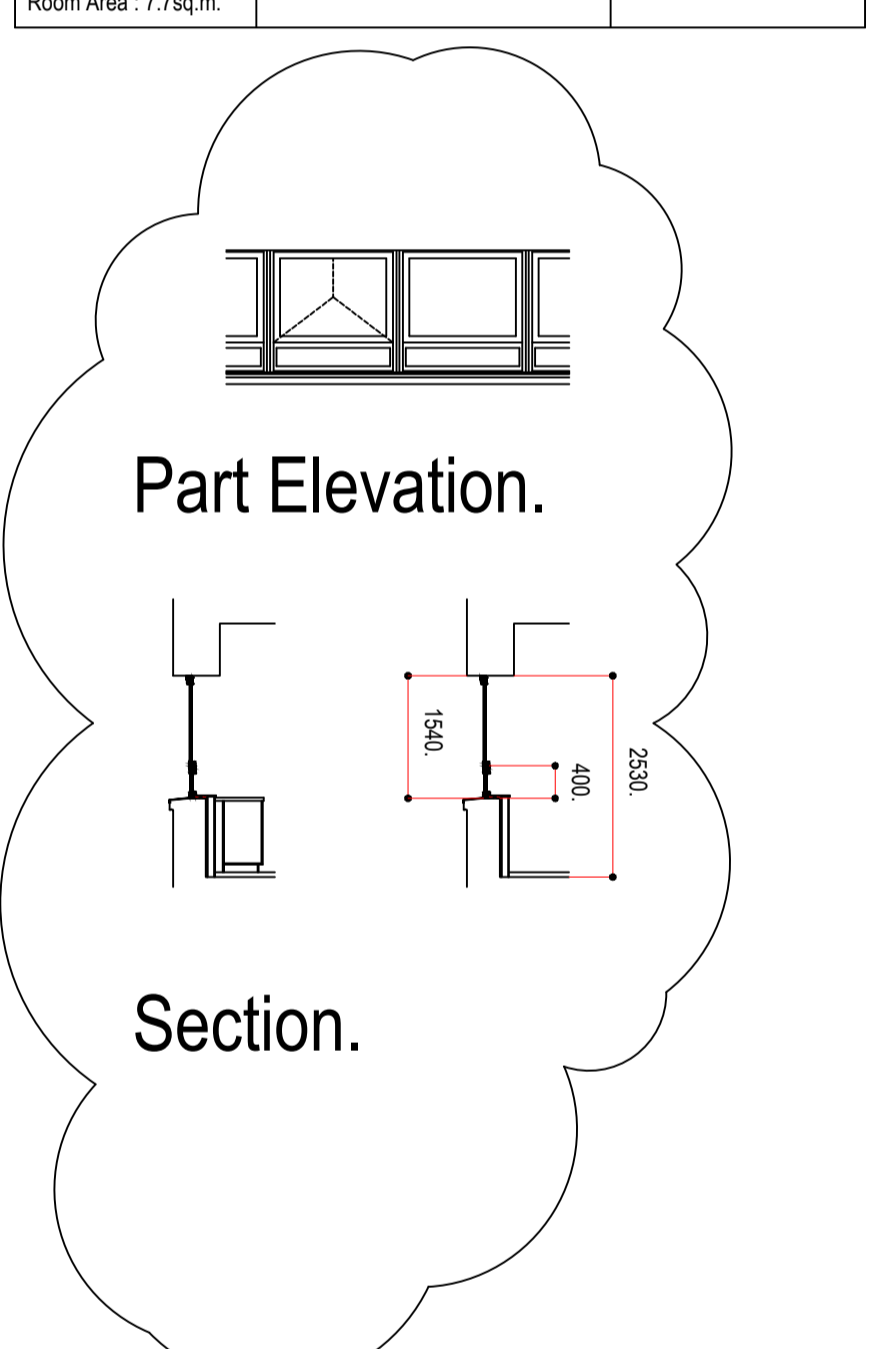

All Sashes Must Open.

CONSTRUCTION ISSUE.
 A: Ramps revised as discussed with Building Control, 03/04/2014.
 B: All window sashes to be openable. 09/04/2014.

East Ayrshire Council
 Finance and Corporate Support,
 Opera House, John Finnie Street,
 Kilmarnock.
 KA1 1DD.
 Tel. 01563 55-5234
 Fax. 01563 55-5235

Project: Proposed Internal Alterations.
 Location: 2 The Cross, Kilmarnock.
 Client: Finance and Corporate Infrastructure EAC.
 Drawing Title: Proposed New 2nd and 3rd Floor Windows.
 Drawing/Project No.: 13-128-FCS-IR.
 Scale: 1:100. Date: January 2014. Drawn: GJB.

Crawing No. **05B.**