

A photograph of a dining area. In the foreground, a light-colored wooden table is set with a glass bottle and two glasses. Several wooden chairs are around the table. The background features a large, arched mural of a lush tropical forest with various plants and birds. The mural is set within a white architectural frame. A black track with spotlights is visible at the top of the image.

Mindspace
Hammersmith





Ideal location, great space

The Metro Building

1 Butterwick, Hammersmith, London W6 8

 **35,000 sqft**

Situated directly across from Hammersmith station, we are at the forefront of the coworking revolution taking London by storm. We're here to support Hammersmith as a major economic and cultural centre, and the go-to choice as the London headquarters for leading global and local companies. We're here to create a workspace environment that is inspiring and welcoming, so you can focus on what you do best - your core business. We welcome teams from enterprises, startups, and SMBs, along with entrepreneurs, freelancers, and independent creatives. Our Hammersmith location places you in the centre of the city's media and luxury ecosystem, alongside a vibrant, professional community. Be where the action is!





Easy to get here



| | | |
|--|------|-------|
| Hammersmith Station (Hammersmith & City and Circle lines) | 0.1m | 3 min |
| Hammersmith Station (District and Piccadilly lines) | 0.2m | 5 min |



| | | |
|-------------------------|-------|--------|
| London Heathrow | 12.5m | 32 min |
| London City Airport | 13.4m | 55 min |
| London Stansted Airport | 46m | 78 min |



| | | |
|-------------------------|-------|--------|
| London Heathrow | 12.5m | 24 min |
| London City Airport | 13.4m | 62 min |
| London Stansted Airport | 46m | 84 min |

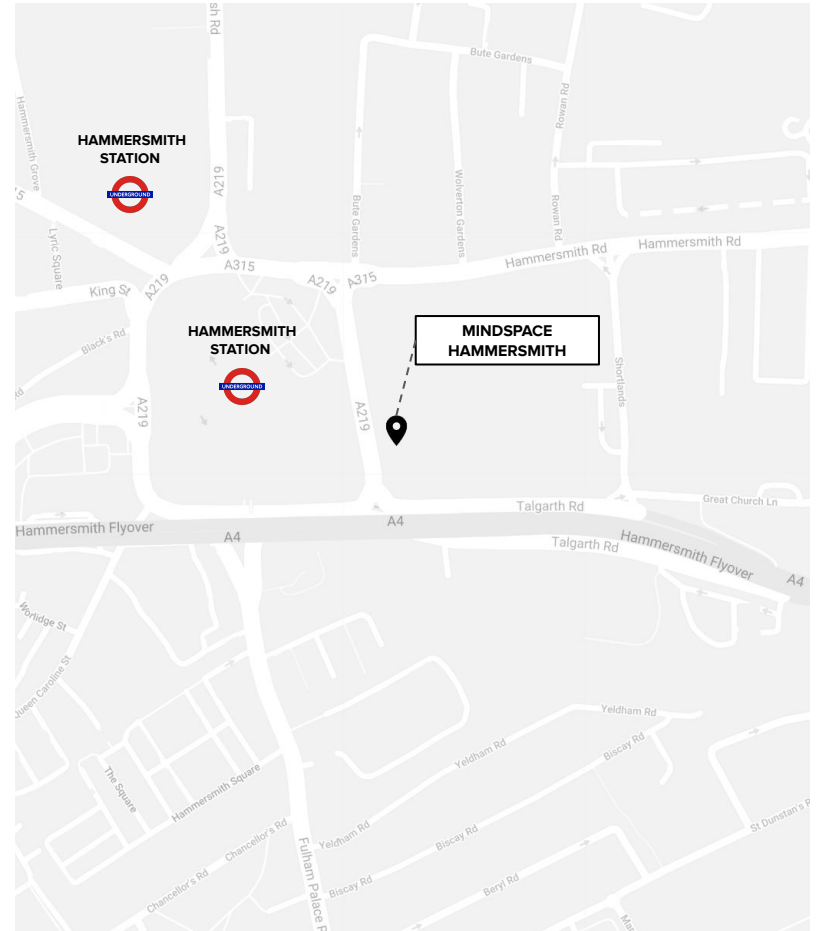



This is Mindspace

Mindspace is a global provider of high-end workspace, designed to serve the growing needs of the world's leading SMBs and enterprises.

With a proven track record of fitting Fortune 500 companies with fully serviced, all-inclusive, and bespoke working environments, Mindspace provides a vast selection of tailorable space, via large dedicated workspaces, team suites, and private offices.

Every site is staffed by a local team of community managers, dedicated to addressing the unique needs of every single member and facilitating connections between different companies.

The community of over 14,000 professionals enjoys a versatile environment with breakout areas, artistic lounges, fully-equipped meeting rooms, and open plan kitchens. Real connections are made among Mindspace members in shared areas, as well as through weekly networking events, professional meetups, and happy hours.

Mindspace has **30 prime locations** in **14 major world cities** across the U.S., the U.K., Germany, Netherlands, Romania, Poland, and Israel. As advocates for international exchange, Mindspace gives members open-ended access to work from every Mindspace location around the world, at no extra charge.



Plug & Play

We've got you covered

Your fully-flexible monthly membership covers absolutely everything. No extra charges. Period.



24/7 Access



Customise your space



Hundreds of benefits



Event spaces



Team on the ground



Mindspace Mobile app



Kitchens & Lounges



IT support



Flexible monthly subscription



Fully equipped meeting rooms



Private phone booths



Ultra-fast Internet & Wi-Fi



Fully furnished offices



Mail and package handling



Coffee, soda & Refreshments



Guest reception



Cleaning services



Global access to Mindspace locations



Weekly happy hours & Professional events



Showers



Rooftop

Floor Plan

6th Floor

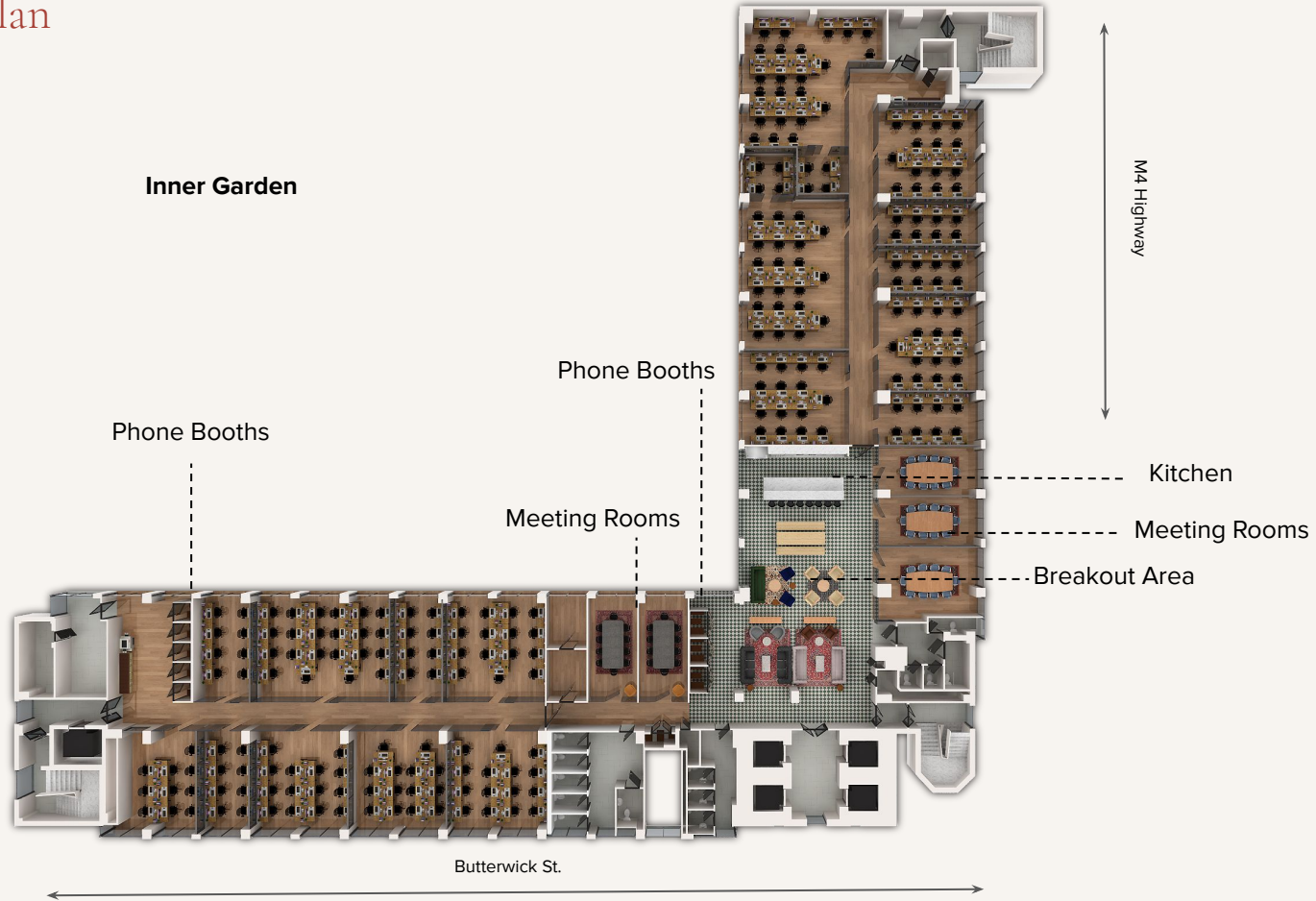

Floor Plan

7th Floor

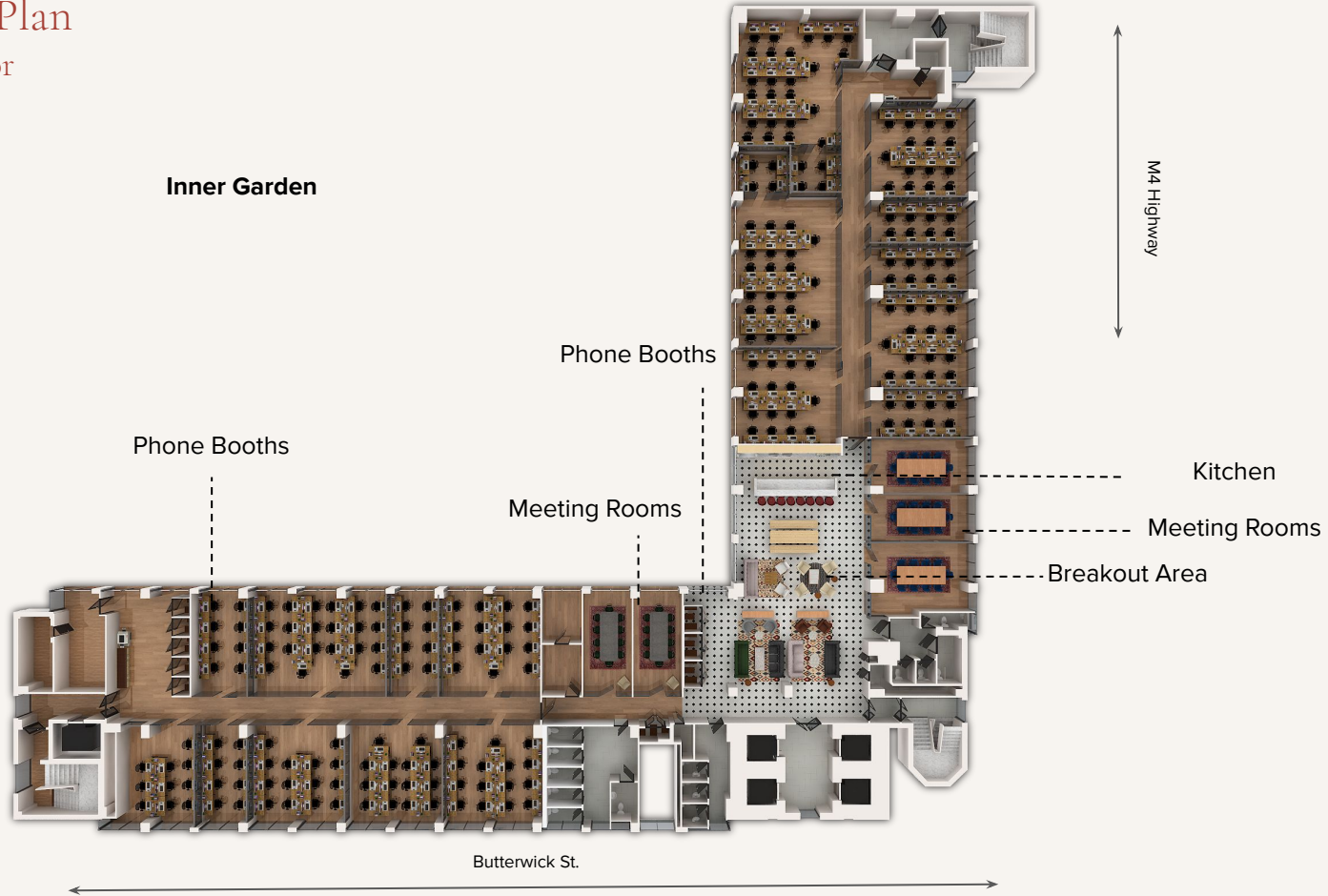

Floor Plan

8th Floor

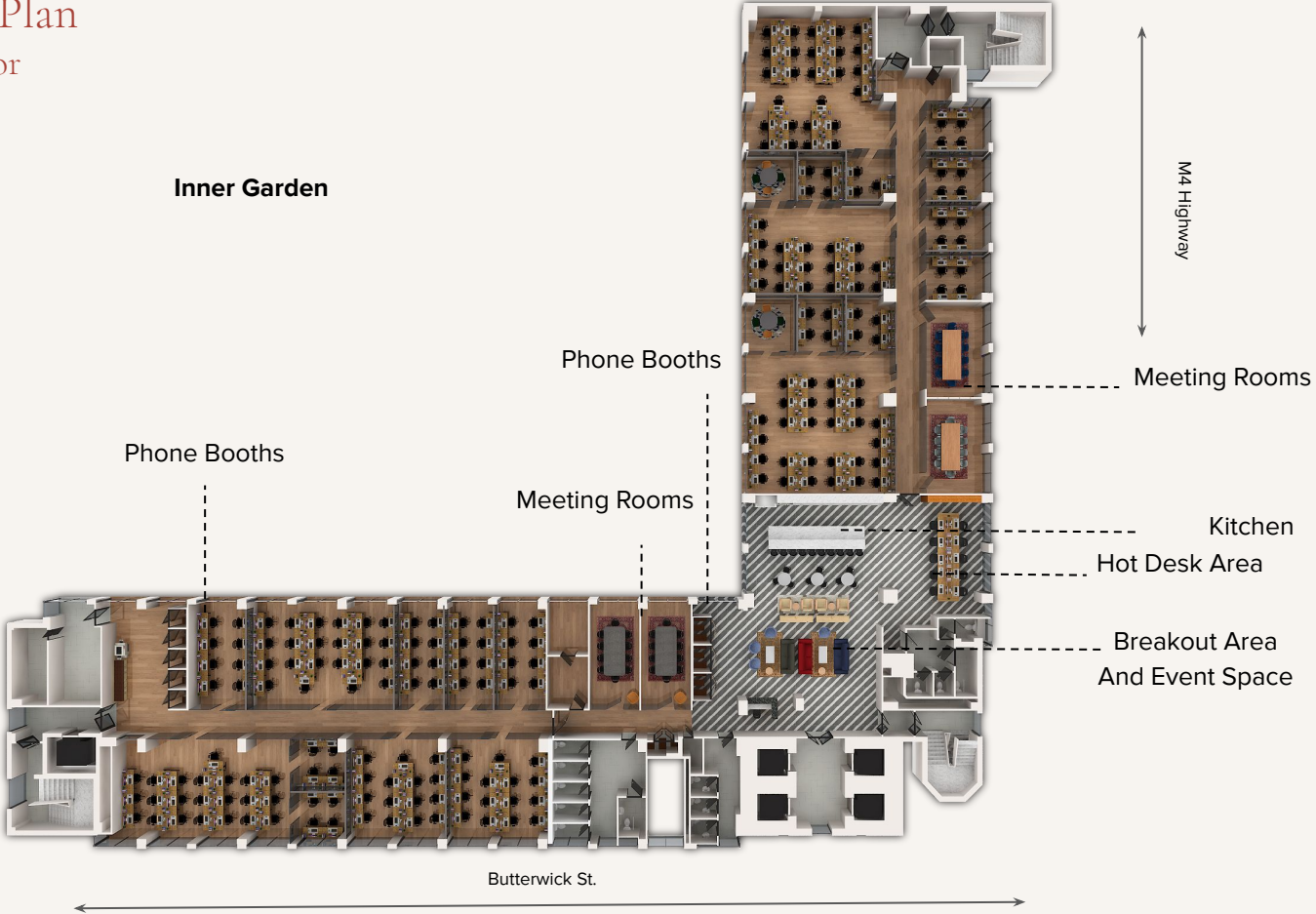

Our Locations

7 countries // 15 cities // 30 locations // ~900,000 SQ FT

- **London**
Aldgate
Shoreditch
Hammersmith
- **Washington, D.C.**
K Street
- **San Francisco**
Market Center
- **Tel aviv**
Ahad Ha'am
Rothschild Blvd
- **Herzliya**
Ha'manofim
- **Ramat Gan**
Habursa
- **Warsaw**
Hala Koszyki
- **Bucharest**
Business District
City Offices
Victoriei
- **Amsterdam**
Herengracht
Wenckebachweg
Nieuwezijds Voorburgwal
Spuistraat
Sophialaan
- **Utrecht**
Churchillaan
Nicolaas beetsstraat
- **Berlin**
Friedrichstraße
Krausenstraße
Skalitzer Straße
- **Hamburg**
Rödingsmarkt
- **Munich**
Viktualienmarkt
Salvatorplatz
Stachus
- **Frankfurt**
Neue Mainzer Str.

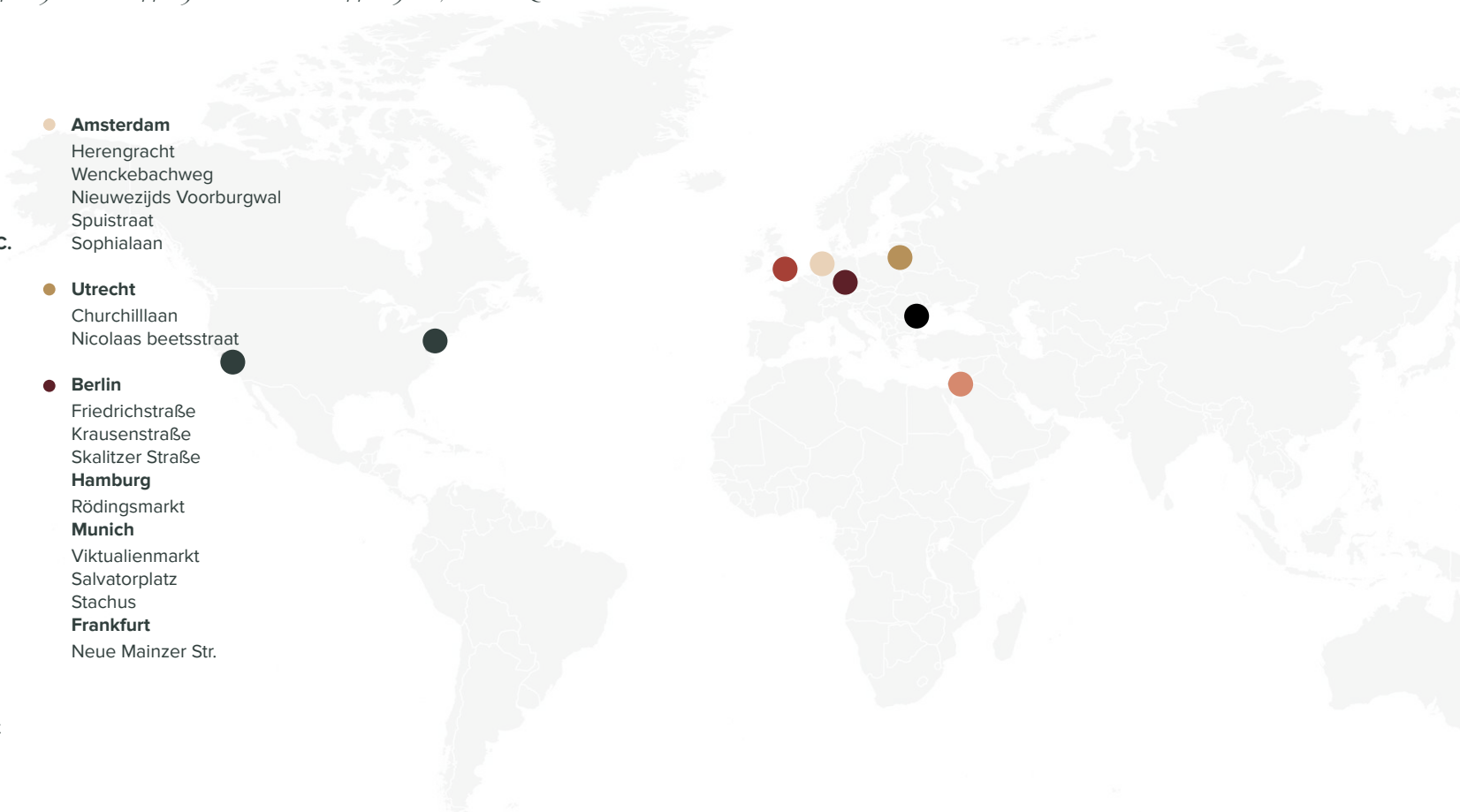

In Good Company

Enterprise Teams Choose Mindspace



Valuable Perks and Benefits

Exclusive member benefits include discounts and unique deals from many global service providers and local partners like Google, Amazon, Microsoft, nearby restaurants, car rentals, hotels and wellness suppliers, helping members in their everyday tasks, as well as providing business solutions at attractive rates.



CHARLES & KEITH



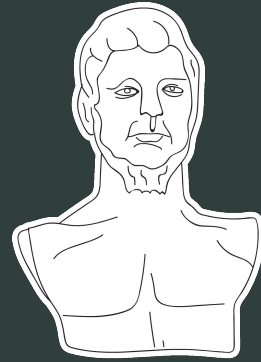

Inspiring Work Environment

Minspace is a curated art exhibition in many ways. Compelling art, towering bookcases and greenery fills the space. Our designers focus their attention on every single detail, ensuring that each space is bespoke and decked out with luxe finishes. We have mirrored light fittings, velvet sofas, fine marble bar tops, and crafted wooden one-on-one booths.