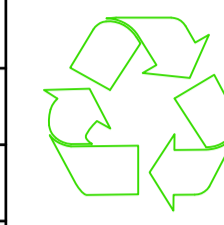

THIS DRAWING IS PROTECTED UNDER COPYRIGHT. THIS DRAWING IS NOT TO BE REPRODUCED IN WHOLE OR PART UNLESS AUTHORISED BY

area² COPYRIGHT

THIS DRAWING IS NOT TO BE SCALED. THE GENERAL CONTRACTOR IS TO CHECK ALL DIMENSIONS AND NOTIFY THE DESIGNERS OF ANY DISCREPANCIES OR OMISSIONS.

DRAWING TO BE READ IN CONJUNCTION WITH SCOPE OF WORKS

CEILING HEIGHT		 <p>THIS DRAWING IS ON RECYCLED PAPER</p>
BEAM HEIGHT		
WINDOW HEIGHT		
SILL HEIGHT		

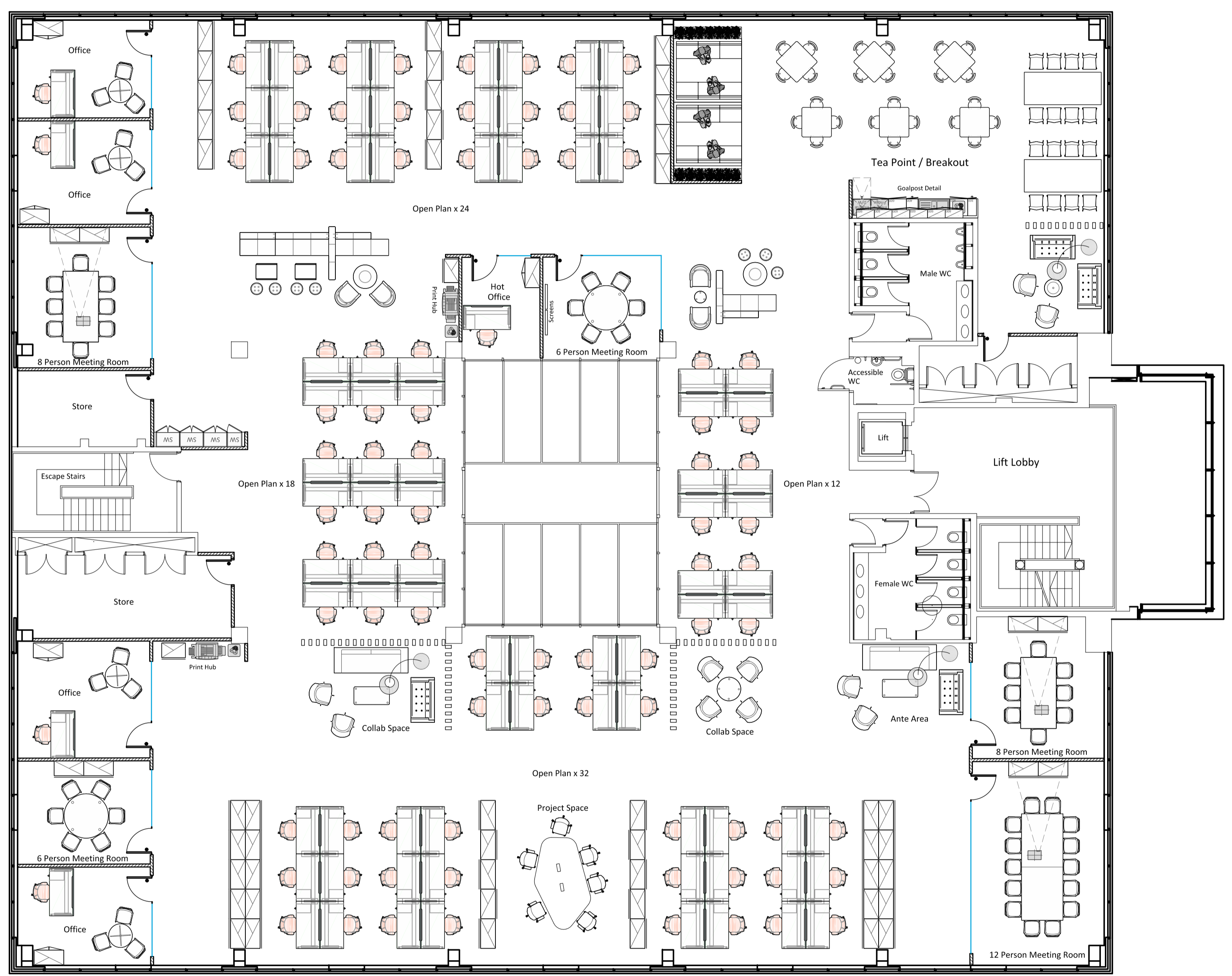

First Floor
 Floor Schedule:
 997 Sqm / 10,731 Sqft

- Workstations - 86
- 4 x Offices
- 1 x Hot Office
- 2 x 6 Person Meeting Room
- 2 x 8 Person Meeting Room
- 1 x 12 Person Meeting Room

Teapoint / Breakout
 Collaboration Zones
 2 x Print Hubs
 Store

Partition Construction Legend

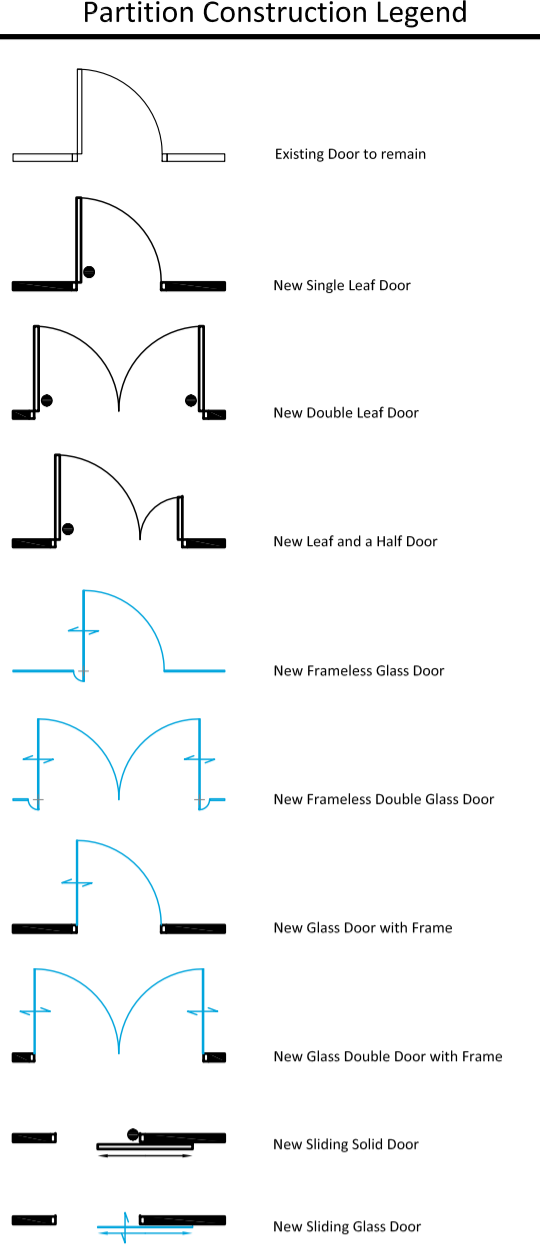

- Existing Door to remain
- New Single Leaf Door
- New Double Leaf Door
- New Leaf and a Half Door
- New Frameless Glass Door
- New Frameless Double Glass Door
- New Glass Door with Frame
- New Glass Double Door with Frame
- New Sliding Solid Door
- New Sliding Glass Door

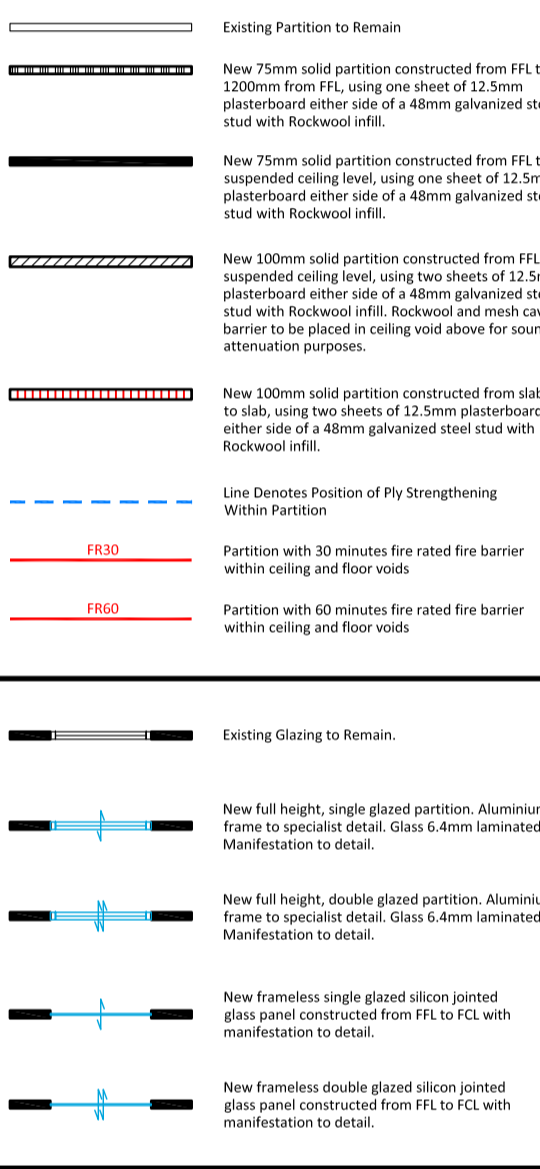

- Existing Partition to Remain
- New 75mm solid partition constructed from FFL to suspended ceiling level, using one sheet of 12.5mm plasterboard either side of a 48mm galvanneal steel stud with Rockwool infill.
- New 75mm solid partition constructed from FFL to suspended ceiling level, using two sheets of 12.5mm plasterboard either side of a 48mm galvanneal steel stud with Rockwool infill.
- New 100mm solid partition constructed from FFL to suspended ceiling level, using two sheets of 12.5mm plasterboard either side of a 48mm galvanneal steel stud with Rockwool infill.
- New 100mm solid partition constructed from slab to slab, using two sheets of 12.5mm plasterboard either side of a 48mm galvanneal steel stud with Rockwool infill.
- Line Denotes Position of Ply Strengthening Within Partition
- FR30 Partition with 30 minutes fire rated fire barrier within ceiling and floor voids
- FR60 Partition with 60 minutes fire rated fire barrier within ceiling and floor voids

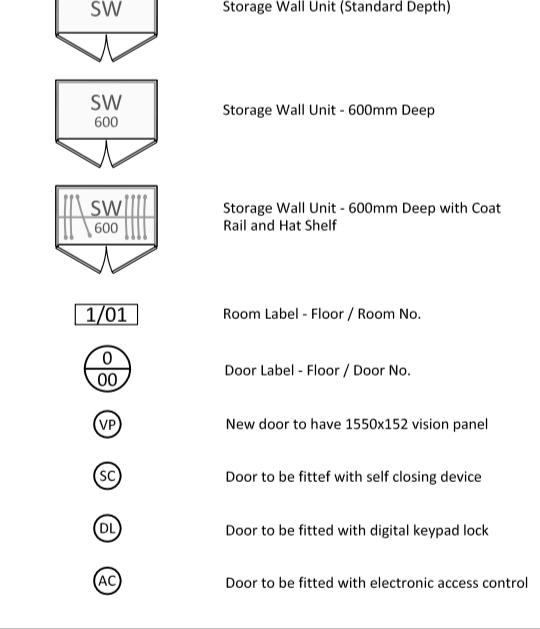

- SW Storage Wall Unit (Standard Depth)
- SW 600 Storage Wall Unit - 600mm Deep
- SW 1000 Storage Wall Unit - 600mm Deep with Coat Rail and Hat Shelf
- 1/01 Room Label - Floor / Room No.
- 0/01 Door Label - Floor / Door No.
- New door to have 350x152 vision panel
- Door to be fitted with self closing device
- Door to be fitted with digital keypad lock
- Door to be fitted with electronic access control

DATE	REV	REVISIONS	SIGN	CHKD

area²
 Fourfront Group

The Old Post Office | 5th Floor,
 33 Station Road, | Counting House,
 Egham, | 53 Tooley Street,
 Surrey TW20 9LA | London SE1 2QN

T. 01784 274000 | T. 020 7089 6000

info@areasq.co.uk | www.areasq.co.uk

DRAWING STATUS
INFORMATION ONLY

CLIENT

PROJECT
 Building 2
 Dorking Office Park
 Station Road
 Dorking Road, Surrey
 RH4 1HJ

TITLE
 Test Fit Plan
 1:8 Occupancy Ratio
 First Floor

SCALE 1:100 @ A1

DATE	06.03.17	DRAWN	RP	CHECKED	JS
------	----------	-------	----	---------	----

PROJECT NO	BLDG.	FLOOR	DETAIL	REV.
XXXX	02	01	-	-

First Floor - Test Fit Plan